

STATE OF FLORIDA
OSCEOLA COUNTY, FLORIDA

CONTRACT PLANS

FINANCIAL PROJECT ID 445415-3-58-01
FEDERAL FUND (FAN D523 042 B)
OSCEOLA COUNTY (92550000)
CR525 (NEPTUNE ROAD)

NEPTUNE ROAD WIDENING FROM PARTIN SETTLEMENT ROAD
TO SOUTH OF KINGS CREST ROAD

INTELLIGENT TRANSPORTATION SYSTEMS PLANS

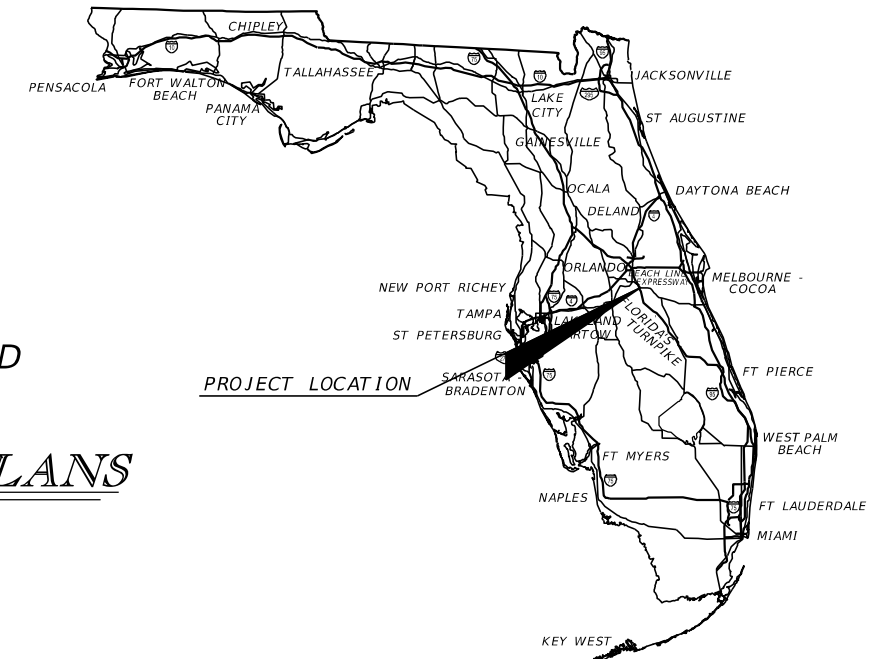

INDEX OF ITS PLANS

SHEET NO.	SHEET DESCRIPTION
IT-1	KEY SHEET
IT-2	SIGNATURE SHEET
IT-3	TABULATION OF QUANTITIES
IT-4	GENERAL NOTES
IT-5 - IT-11	ITS PLAN
IT-12 - IT-14	WIRING DIAGRAMS
IT-15	MANAGED FIELD ETHERNET SWITCH DETAIL
IT-16 - IT-17	MOUNTING DETAILS
IT-18 - IT-20	SPLICE DIAGRAM
IT-21	REPORT OF SPT BORINGS FOR CCTV POLES



INTELLIGENT TRANSPORTATION SYSTEMS PLANS

ENGINEER OF RECORD:

KEVIN R. CAREY, P.E. NO.: 61635
FALLER, DAVIS & ASSOCIATES, INC.
2301 MAITLAND CENTER PARKWAY, SUITE 265
MAITLAND, FL 32751
(407) 644-2116
CONTRACT NO.: PS-20-11312-DG
VENDOR NO.: 59-2594956

COUNTY PROJECT MANAGER:

KYLE DORRIS, PE

CONSTRUCTION CONTRACT NO.	FISCAL YEAR	SHEET NO.
N/A	23	IT-1

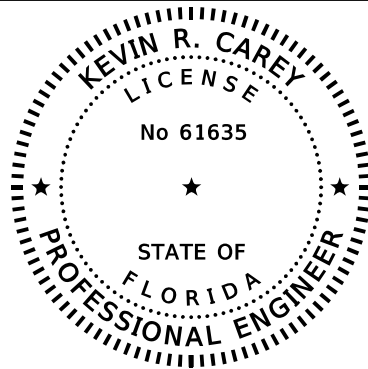

THIS ITEM HAS BEEN DIGITALLY
SIGNED AND SEALED BY

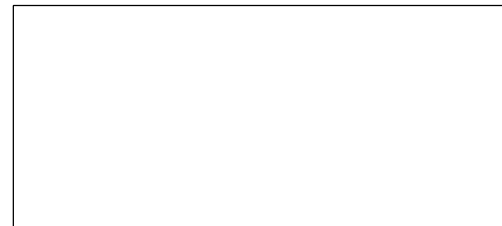

ON THE DATE ADJACENT TO THE SEAL

PRINTED COPIES OF THIS DOCUMENT ARE
NOT CONSIDERED SIGNED AND SEALED
AND THE SIGNATURE MUST BE VERIFIED
ON ANY ELECTRONIC COPIES.

FALLER, DAVIS & ASSOCIATES, INC.
2301 MAITLAND CENTER PARKWAY, SUITE 265
MAITLAND, FL 32751
KEVIN R. CAREY, P.E. NO. 61635

THE ABOVE NAMED PROFESSIONAL ENGINEER SHALL BE RESPONSIBLE FOR THE
FOLLOWING SHEETS IN ACCORDANCE WITH RULE 61G15-23.004, F.A.C.

SHEET NO.	SHEET DESCRIPTION
IT-1	KEY SHEET
IT-2	SIGNATURE SHEET
IT-3	TABULATION OF QUANTITIES
IT-4	GENERAL NOTES
IT-5 - IT-11	ITS PLAN
IT-12 - IT-14	WIRING DIAGRAMS
IT-15	MANAGED FIELD ETHERNET SWITCH DETAIL
IT-16 - IT-17	MOUNTING DETAILS
IT-18 - IT-20	SPLICE DIAGRAM

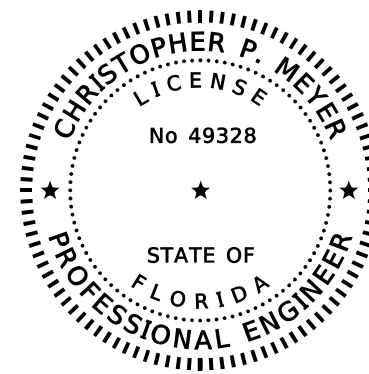

THIS ITEM HAS BEEN DIGITALLY
SIGNED AND SEALED BY



ON THE DATE ADJACENT TO THE SEAL

PRINTED COPIES OF THIS DOCUMENT ARE
NOT CONSIDERED SIGNED AND SEALED
AND THE SIGNATURE MUST BE VERIFIED
ON ANY ELECTRONIC COPIES.

GEOTECHNICAL AND ENVIRONMENTAL CONSULTANTS, INC.
2510 MICHIGAN AVENUE, SUITE D
KISSIMMEE, FL 34744
CHRISTOPHER P. MEYER, P.E. NO. 49328

THE ABOVE NAMED PROFESSIONAL ENGINEER SHALL BE RESPONSIBLE FOR THE
FOLLOWING SHEETS IN ACCORDANCE WITH RULE 61G15-23.004, F.A.C.

SHEET NO.	SHEET DESCRIPTION
IT-2	SIGNATURE SHEET
IT-21	REPORT OF SPT BORINGS FOR CCTV POLES

REVISIONS				KEVIN R. CAREY, P.E. P.E. LICENSE NUMBER 61635 FALLER, DAVIS & ASSOCIATES, INC. 2301 MAITLAND CENTER PARKWAY, SUITE 265 MAITLAND, FL 32751	 OSCEOLA COUNTY TRANSIT AND TRANSPORTATION 1 COURTHOUSE SQUARE, SUITE 3100 KISSIMMEE, FLORIDA 34741-5488 PHONE:(407) 742-0662 FAX:(407) 742-0600	<i>SIGNATURE SHEET</i>	SHEET NO.
DATE	DESCRIPTION	DATE	DESCRIPTION				IT-2

TABULATION OF QUANTITIES

PAY ITEM NO.	DESCRIPTION	UNIT	SHEET NUMBERS														TOTAL THIS SHEET		GRAND TOTAL	
			IT-5		IT-6		IT-7		IT-8		IT-9		IT-10		IT-11		PLAN	FINAL	PLAN	FINAL
			PLAN	FINAL	PLAN	FINAL	PLAN	FINAL	PLAN	FINAL	PLAN	FINAL	PLAN	FINAL						
630-2-11	CONDUIT, FURNISH & INSTALL, OPEN TRENCH	LF	938		704		2527		2280		1579		1098		296		9422		9422	
630-2-12	CONDUIT, FURNISH & INSTALL, DIRECTIONAL BORE	LF	907		1904		634		326		1021		1675		294		6761		6761	
630-2-14	CONDUIT, FURNISH & INSTALL, ABOVEGROUND	LF	25										10				35		35	
633-1-121	FIBER OPTIC CABLE, F&I, UNDERGROUND, 2-12 FIBERS	LF	127										310				437		437	
633-1-122	FIBER OPTIC CABLE, F&I, UNDERGROUND, 13-48 FIBERS	LF					115										115		115	
633-1-420	FIBER OPTIC CABLE, RELOCATE, UNDERGROUND	LF	1327		1402		2106		1402		1550		1701		294		9782		9782	
633-2-31	FIBER OPTIC CONNECTION, INSTALL, SPLICE	EA	24				48						24				96		96	
633-3-11	FIBER OPTIC CONNECTION HARDWARE, F&I, SPLICE ENCLOSURE	EA	1				1						1				3		3	
633-3-12	FIBER OPTIC CONNECTION HARDWARE, F&I, SPLICE TRAY	EA	2				4						2				8		8	
633-3-15	FIBER OPTIC CONNECTION HARDWARE, F&I, PRETERMINATED PATCH PANEL	EA	1				1						1				3		3	
635-2-11	PULL & SPLICE BOX, FURNISH & INSTALL, 13" X 24" COVER SIZE	EA	11		6		8		4		4		9				42		42	
635-2-12	PULL & SPLICE BOX, FURNISH & INSTALL, 24" X 36" COVER SIZE	EA	4		2		2		2		1		1				12		12	
635-2-13	PULL & SPLICE BOX, FURNISH & INSTALL, 30" X 60" RECTANGULAR COVER SIZE	EA	1				1				1		2				5		5	
639-1-122	ELECTRICAL POWER SERVICE, F&I, UNDERGROUND, METER PURCHASED BY CONTRACTOR	AS											1				1		1	
639-2-1	ELECTRICAL SERVICE WIRE, F&I	LF											32				32		32	
641-2-12	PRESTRESSED CONCRETE POLE, F&I, TYPE P-11 SERVICE POLE	EA											1				1		1	
641-3-163	CONCRETE CCTV POLE, F&I WITH LOWERING DEVICE, 63'	EA											1				1		1	
660-6-121	VEHICLE DETECTION SYSTEM- AVI, BLUETOOTH, FURNISH & INSTALL, CABINET EQUIPMENT	EA	1				1						1				3		3	
660-6-122	VEHICLE DETECTION SYSTEM- AVI, BLUETOOTH, FURNISH & INSTALL, ABOVE GROUND EQUIPMENT	EA	1				1						1				3		3	
676-1-500	TRAFFIC SIGNAL CONTROLLER CABINET, ADJUST/MODIFY	EA	1														1		1	
676-2-122	ITS CABINET, F&I, POLE MOUNT WITH SUNSHIELD, 336S 24"W X 46"H X 22" D	EA											1				1		1	
682-1-143	ITS CCTV CAMERA, F&I, EXTERNAL POSITIONER PTZ - NON-PRESSURIZED, 1P, HIGH DEFINITION	EA	1				1						1				3		3	
684-1-1	MANAGED FIELD ETHERNET SWITCH, F&I	EA	1				1						1				3		3	
685-1-11	UNINTERRUPTIBLE POWER SUPPLY, FURNISH AND INSTALL, LINE INTERACTIVE	EA											1				1		1	
685-1-13	UNINTERRUPTIBLE POWER SUPPLY, FURNISH AND INSTALL, LINE INTERACTIVE WITH CABINET	EA	1														1		1	
685-2-1	REMOTE POWER MANAGEMENT UNIT - RPMU, FURNISH & INSTALL	EA	1										1				2		2	

PAY ITEM NOTES:

PAY ITEM NUMBER 633-1-420 IS PROVIDED TO RELOCATE THE 10,000' OF 96SM FOC STORED UNDER FPID 445415-2-58-01.

PAY ITEM NUMBER 676-1-500 INCLUDES MODIFICATIONS TO THE CONTROLLER CABINET ASSEMBLY INCLUDING CORE DRILLING ADDITIONAL CONDUITS AND ROUTING OF CCTV CAMERA, BLUETOOTH, AND FIBER OPTIC CABLES. DRILLING INTO THE SIDE OF THE CABINET OR USE OF AN LB ON THE SIDE OF THE TRAFFIC CABINET IS NOT PERMITTED. CORE DRILLING ADDITIONAL CONDUITS IN THE BOTTOM OF THE CABINET IS PERMITTED.

PAY ITEM NUMBER 676-2-122 INCLUDES CABLE MANAGEMENT DUCTS.

PAY ITEM NUMBER 684-1-1 INCLUDES COST OF ALL CABLING TO CONNECT EXISTING AND PROPOSED DEVICES.

PAY ITEM NUMBER 685-2-1 INCLUDES A UNIT WITH A MINIMUM OF 8, 5-15 NEMA 120 VAC OUTLETS.

REVISIONS			
DATE	DESCRIPTION	DATE	DESCRIPTION

KEVIN R. CAREY, P.E.
 P.E. LICENSE NUMBER 61635
 FALLER, DAVIS & ASSOCIATES, INC.
 2301 MAITLAND CENTER PARKWAY, SUITE 265
 MAITLAND, FL 32751



OSCEOLA COUNTY TRANSIT AND TRANSPORTATION
 1 COURTHOUSE SQUARE, SUITE 3100
 KISSIMMEE, FLORIDA 34741-5488
 PHONE:(407) 742-0662 FAX:(407) 742-0600

TABULATION OF QUANTITIES

SHEET NO.
 IT-3

THE OFFICIAL RECORD OF THIS SHEET IS THE ELECTRONIC FILE DIGITALLY SIGNED AND SEALED UNDER RULE 61G15-23.004, F.A.C.

GENERAL NOTES:

- CONTACT OSCEOLA COUNTY (407-742-0565) TWO BUSINESS DAYS PRIOR TO BEGINNING WORK. THE MAINTAINING AGENCY IS OSCEOLA COUNTY.
- SCHEDULE AN INTEGRATION MEETING WITH OSCEOLA COUNTY TWO BUSINESS DAYS IN ADVANCE OF ACTIVATING THE DEVICES ON THE FDOT NETWORK.
- SCHEDULE A MEETING WITH OSCEOLA COUNTY NETWORK ENGINEERING STAFF TWO DAYS PRIOR TO ACCESSING OR SPLICING ANY FOC.
- UTILITY INFORMATION IS PROVIDED IN THE ROADWAY PLAN SET.

CABLING NOTES:

- POWER CABLES AND COMMUNICATIONS CABLES SHALL NOT OCCUPY THE SAME CABLE MANAGEMENT RACEWAY.
- ALL CABLE MANAGEMENT EQUIPMENT SHALL HAVE BRACKETS THAT ALLOW THE CABLE MANAGEMENT EQUIPMENT TO CONNECT TO THE RACK WHILE STILL ALLOWING OTHER EQUIPMENT TO BE INSTALLED OR REMOVED WITHOUT HAVING TO ADJUST OR REMOVE THE CABLE MANAGEMENT EQUIPMENT. ZIP TIES ARE NOT ALLOWED ON ANY COMMUNICATIONS CABLING. IF CABLES NEED TO BE SECURED OUTSIDE THE CABLE MANAGEMENT EQUIPMENT (I.E. PANDUIT, NEAT PATCH, ETC), THEN VELCRO IS ACCEPTABLE FOR THIS PURPOSE.
- SLACK FIBER OPTIC CABLE SHALL NOT BE STORED IN THE TRAFFIC SIGNAL CONTROLLER OR ITS CABINETS.

CONDUIT:

- HDPE CONDUIT COLOR CODES:
 - BACKBONE:
 - BLUE (FIBER & COMPOSITE IF REQUIRED)
 - BLUE W/WHITE STRIPE (LOCATE TONE WIRE)
 - DROP CABLE:
 - BLUE (FIBER & COMPOSITE IF REQUIRED)
 - BLUE W/WHITE STRIPE (LOCATE TONE WIRE)
 - POWER:
 - RED
 - RED W/WHITE STRIPE (SPARE)









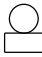

PULL BOXES:

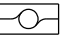
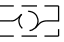
- THE STACKING OF PULL BOXES IS NOT ALLOWED.
- INSTALL WIRE GROUNDING UNITS (WGU) AT EACH SPLICE VAULT.

LIGHTING DESIGN:

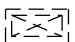
- THE LOCATION OF THE CONDUITS AND PULL BOXES ARE DIAGRAMMATIC ONLY AND MAY BE SHIFTED BY THE ENGINEER TO ACCOMMODATE LOCAL CONDITIONS AND EXISTING UTILITY LOCATIONS.
- LIGHTING CONDUIT AND PULL BOXES TO BE INSTALLED AS SHOWN IN THE PLANS FOR FUTURE LIGHT POLE INSTALLATIONS BY KISSIMMEE UTILITY AUTHORITY (KUA).

LEGEND:

-  PROPOSED POWER SERVICE POLE/POWER SERVICE
-  PROPOSED PULL BOX
-  PROPOSED FOC PULL BOX
-  PROPOSED FOC RECTANGULAR VAULT
-  EXISTING FOC RECTANGULAR VAULT
-  PROPOSED CCTV CAMERA POLE
-  PROPOSED CCTV CAMERA
-  PROPOSED BLUETOOTH READER
-  EXISTING TRAFFIC CONTROLLER CABINET
-  PROPOSED POLE MOUNTED ITS 336S CABINET
-  SC TO SC PATCH CORDS
-  PROPOSED OPEN TRENCH CONDUIT
-  PROPOSED DIRECTIONAL BORE CONDUIT

FIBER:

- 10,000 FEET OF 96 SM FIBER WILL BE STORED IN SPARE CONDUIT ALONG CR 525 (NEPTUNE ROAD) UNDER FPID 445415-2-58-01. THE STORED FIBER WILL BE RELOCATED TO THE PROPOSED CONDUIT AND PULL BOXES INSTALLED UNDER THIS PROJECT AND CONNECTED AS SHOWN IN THE PLANS.

KUA NOTES:

- ELECTRICAL SERVICE WILL NOT BE ENERGIZED UNTIL:
 - SPECIFICATIONS AND REQUIREMENTS ARE MET.
 - A CONTRACT FOR ELECTRICAL SERVICE HAS BEEN MADE. (CALL KUA CUSTOMER SERVICE AT (407) 933-9800)
 - THE ELECTRICAL SERVICE HAS PASSED LOCAL AUTHORITY INSPECTION AND KUA HAS BEEN NOTIFIED BY THAT AUTHORITY.
- KUA SPEC BOOK --> <https://kua.com/wp-content/uploads/2022/05/Electric-Service-and-Metering-Requirements-5-4-2022-.pdf>
- COMMERCIAL SERVICES, THE POINT OF SERVICE IS THE SERVICE/TRANSFORMER/SECONDARY BOX. THEREFORE, IT IS THE RESPONSIBILITY OF THE OWNER/DEVELOPER TO FURNISH, INSTALL, AND MAINTAIN THE ELECTRIC SERVICE CONDUIT AND CONDUCTOR.
- WHERE ELECTRICAL CONDUIT IS REQUIRED FOR USE IN KUA'S INFRASTRUCTURE, KUA'S CONDUIT INSPECTOR WILL NEED TO BE CONTACTED TO INSPECT THEM FOR PROPER DEPTH. FOR CONDUIT INSPECTIONS CALL (407) 933-777 EXT. 6604.

ABBREVIATIONS

- BT BLUETOOTH
- CCTV CLOSED CIRCUIT TELEVISION
- DC DIRECT CURRENT
- FOC FIBER OPTIC CABLE
- MFES MANAGED FIELD ETHERNET SWITCH
- MMU MALFUNCTION MANAGEMENT UNIT
- RPMU REMOTE POWER MANAGEMENT UNIT
- RX RECEIVE
- SM SINGLE MODE
- SPD SURGE PROTECTION DEVICE
- TX TRANSMIT
- UPS UNINTERRUPTIBLE POWER SUPPLY
- VAC VOLTAGE ALTERNATING CURRENT

SPLICE DIAGRAM LEGEND

- = EXISTING FUSION SPLICE
- = PROPOSED FUSION SPLICE
- x = COIL WITHIN SPLICE ENCLOSURE
- SM = SINGLE MODE
- FOC = FIBER OPTIC CABLE
- BL = BLUE
- OR = ORANGE
- GR = GREEN
- BR = BROWN
- SL = SLATE
- WH = WHITE
- RE = RED
- BLK = BLACK
- YL = YELLOW
- VI = VIOLET
- RO = ROSE
- AQ = AQUA

DEVICE INFORMATION SUMMARY

ITS HUB NO:	INTERSECTING ROAD	STA.	CABINET REQUIRED	SPLICE DIAGRAM	MOUNTING DETAILS	WIRING DIAGRAMS
-	PARTIN SETTLEMENT ROAD	32+04, 62' RT	EXISTING TRAFFIC CONTROLLER CABINET	1	1 (TYP. 1)	1
-	CROSS PRAIRIE PARKWAY	29+04, 73' LT	PROPOSED TRAFFIC CONTROLLER CABINET	2	1 (TYP. 2)	2
1	KINGS CREST ROAD	71+34, 69' RT	336S	3	2	3

REVISIONS				KEVIN R. CAREY, P.E. P.E. LICENSE NUMBER 61635 FALLER, DAVIS & ASSOCIATES, INC. 2301 MAITLAND CENTER PARKWAY, SUITE 265 MAITLAND, FL 32751	 OSCEOLA COUNTY TRANSIT AND TRANSPORTATION 1 COURTHOUSE SQUARE, SUITE 3100 KISSIMMEE, FLORIDA 34741-5488 PHONE:(407) 742-0662 FAX:(407) 742-0600	SHEET NO. GENERAL NOTES IT-4
DATE	DESCRIPTION	DATE	DESCRIPTION			

THE OFFICIAL RECORD OF THIS SHEET IS THE ELECTRONIC FILE DIGITALLY SIGNED AND SEALED UNDER RULE 61G15-23.004, F.A.C.

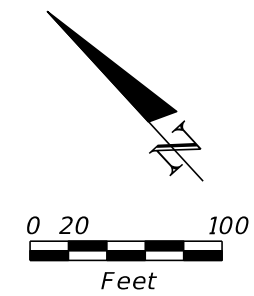

MOUNT TO NE
 EXISTING MAST ARM
 STA. 0+00, 51' LT
 1 RUN @ 34' (CCTV)
 34 LF 630-2-11
 25 LF 630-2-14
 1 EA 682-1-143

630-2-12 156 LF
 2 RUNS @ 156'
 (LIGHTING,
 LOCATE WIRE)

105 LF 630-2-12
 105 LF 633-1-420
 4 RUNS @ 105'
 (FIBER, CCTV, SPARE
 LOCATE WIRE)

633-1-420 50 LF
 635-2-12 1 EA

630-2-11 442 LF
 633-1-420 442 LF
 4 RUNS @ 442'
 (FIBER,
 LOCATE WIRE,
 SPARE, LIGHTING)

630-2-12 145 LF
 633-1-420 145 LF
 4 RUNS @ 145'
 (FIBER, SPARE,
 LOCATE WIRE,
 LIGHTING)

BEGIN ITS STA. 32+04
 OF SURVEY

EXISTING TRAFFIC
 CONTROLLER CABINET
 STA. 32+04, 62' RT
 3 RUNS @ 37'
 (CCTV, FIBER, POWER, SPARE)
 37 LF 630-2-11
 27 LF 633-1-121
 12 EA 633-2-31
 1 EA 633-3-12
 1 EA 633-3-15
 1 EA 660-6-121
 1 EA 660-6-122
 1 EA 676-1-500
 1 EA 684-1-1
 1 EA 685-1-13
 1 EA 685-2-1

SEE DETAIL A
 633-1-121 100 LF
 633-1-420 200 LF
 633-2-31 12 EA
 633-3-11 1 EA
 633-3-12 1 EA
 635-2-13 1 EA

635-2-11 11 EA

110 LF 630-2-12
 110 LF 633-1-420
 4 RUNS @ 110'
 (FIBER, SPARE,
 LOCATE WIRE,
 LIGHTING)

633-1-420 50 LF
 635-2-12 1 EA

630-2-11 210 LF
 2 RUNS @ 210'
 (LIGHTING,
 LOCATE WIRE)

633-1-420 50 LF
 635-2-12 1 EA

630-2-12 266 LF
 2 RUNS @ 266'
 (LIGHTING,
 LOCATE WIRE)

633-1-420 50 LF
 635-2-12 1 EA

630-2-11 215 LF
 2 RUNS @ 215'
 (LIGHTING,
 LOCATE WIRE)

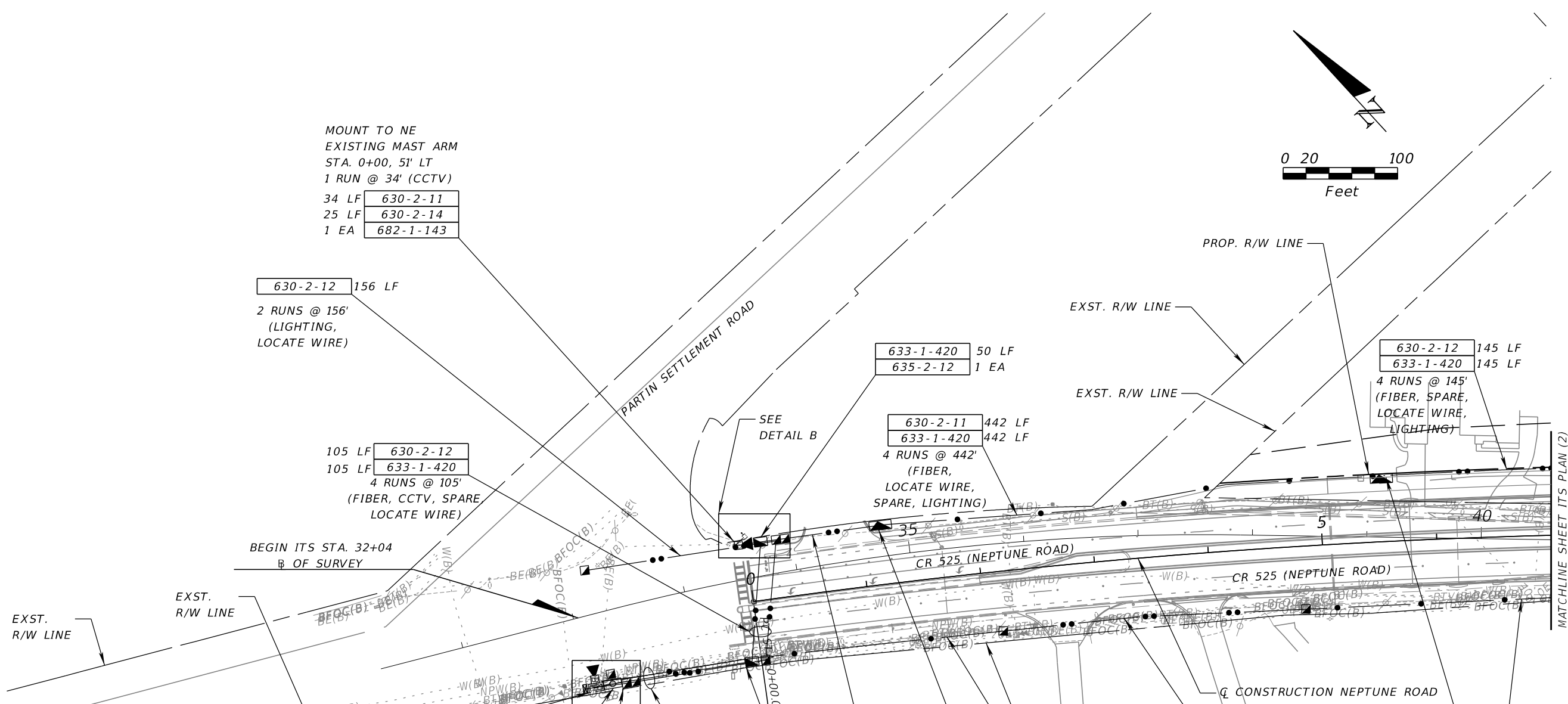
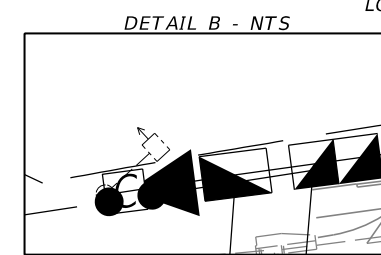
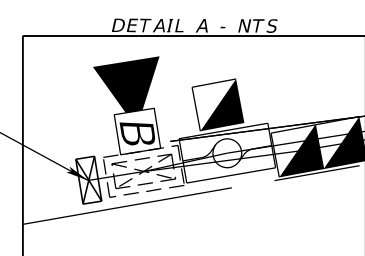

MATCHLINE SHEET ITS PLAN (2)

REVISIONS			
DATE	DESCRIPTION	DATE	DESCRIPTION

KEVIN R. CAREY, P.E.
 P.E. LICENSE NUMBER 61635
 FALLER, DAVIS & ASSOCIATES, INC.
 2301 MAITLAND CENTER PARKWAY, SUITE 265
 MAITLAND, FL 32751



OSCEOLA COUNTY TRANSIT
 AND TRANSPORTATION
 1 COURTHOUSE SQUARE, SUITE 3100
 KISSIMMEE, FLORIDA 34741-5488
 PHONE:(407) 742-0662 FAX:(407) 742-0600

ITS PLAN (1)

SHEET
 NO.
IT-5

THE OFFICIAL RECORD OF THIS SHEET IS THE ELECTRONIC FILE DIGITALLY SIGNED AND SEALED UNDER RULE 61G15-23.004, F.A.C.

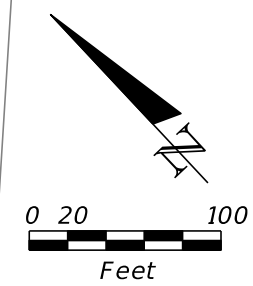
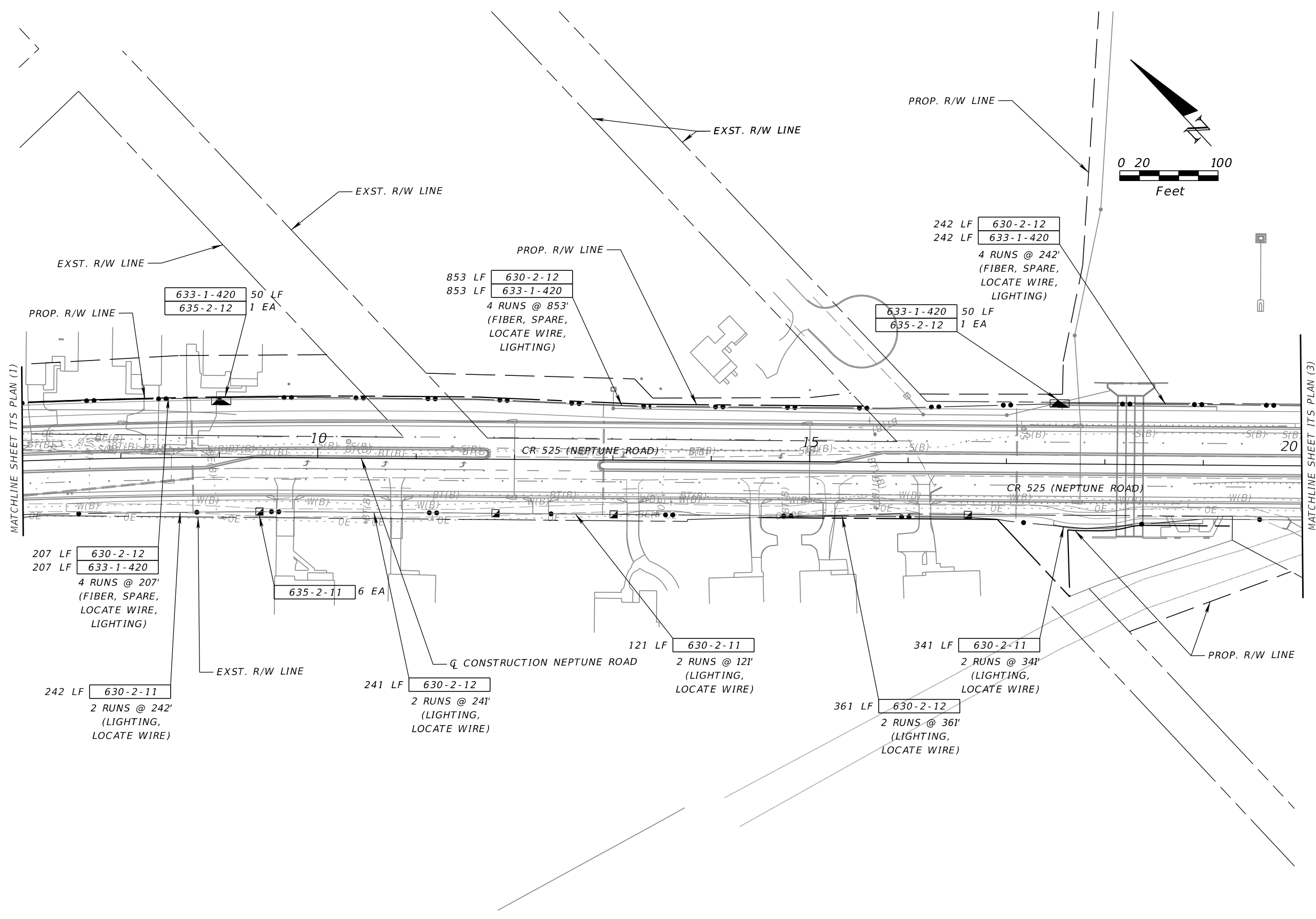

MATCHLINE SHEET ITS PLAN (1)

MATCHLINE SHEET ITS PLAN (3)

REVISIONS			
DATE	DESCRIPTION	DATE	DESCRIPTION

KEVIN R. CAREY, P.E.
 P.E. LICENSE NUMBER 61635
 FALLER, DAVIS & ASSOCIATES, INC.
 2301 MAITLAND CENTER PARKWAY, SUITE 265
 MAITLAND, FL 32751

**OSCEOLA COUNTY TRANSIT
AND TRANSPORTATION**

1 COURTHOUSE SQUARE, SUITE 3100
 KISSIMMEE, FLORIDA 34741-5488
 PHONE: (407) 742-0662 FAX: (407) 742-0600

ITS PLAN (2)

SHEET
NO.
IT-6

THE OFFICIAL RECORD OF THIS SHEET IS THE ELECTRONIC FILE DIGITALLY SIGNED AND SEALED UNDER RULE 61G15-23.004, F.A.C.

NOTE:
 DISCONNECT EXISTING 72 SM FOC FROM THE EXISTING SPLICE VAULT NEAR THE EXISTING CABINET AND PULL BACK TO THE EXISTING FOC VAULT SHOWN. REROUTE EXISTING 72 SM FOC THROUGH THE PROPOSED CONDUIT AND SPLICE TO PROPOSED 48 SM DROP CABLE IN PROPOSED SPLICE VAULT.

PROPOSED TRAFFIC CONTROLLER CABINET, MFES, UPS, AND RPMU ARE PAID FOR IN SIGNALIZATION PLANS STA. 29+04, 73' LT
 2 RUNS @ 15' (FIBER, SPARE)
 15 LF 630-2-11
 15 LF 633-1-122
 24 EA 633-2-31
 2 EA 633-3-12
 1 EA 633-3-15
 1 EA 660-6-121
 1 EA 660-6-122
 1 EA 684-1-1

EXISTING OSCEOLA COUNTY FOC VAULT TO REMAIN STA. 525+17, 46' LT

505 LF 630-2-11
 505 LF 633-1-420
 3 RUNS @ 505' (FIBER, SPARE, LOCATE WIRE)
 SEE NOTE

152 LF 630-2-12
 152 LF 633-1-420
 4 RUNS @ 152' (FIBER, SPARE, LOCATE WIRE, LIGHTING)

4 RUNS @ 165' (FIBER, SPARE, LOCATE WIRE, LIGHTING)
 165 LF 630-2-12
 165 LF 633-1-420

CONSTRUCTION NEPTUNE ROAD
 EXST. R/W LINE
 633-1-420 50 LF
 635-2-12 1 EA

731 LF 630-2-11
 731 LF 633-1-420
 4 RUNS @ 731' (FIBER, SPARE, LOCATE WIRE, LIGHTING)

633-1-122 100 LF
 633-1-420 200 LF
 633-2-31 24 EA
 633-3-11 1 EA
 633-3-12 2 EA
 635-2-13 1 EA

633-1-420 50 LF
 635-2-12 1 EA

253 LF 630-2-11
 253 LF 633-1-420
 4 RUNS @ 253' (FIBER, SPARE, LOCATE WIRE, LIGHTING)

MATCHLINE SHEET ITS PLAN (2)

MATCHLINE SHEET ITS PLAN (4)

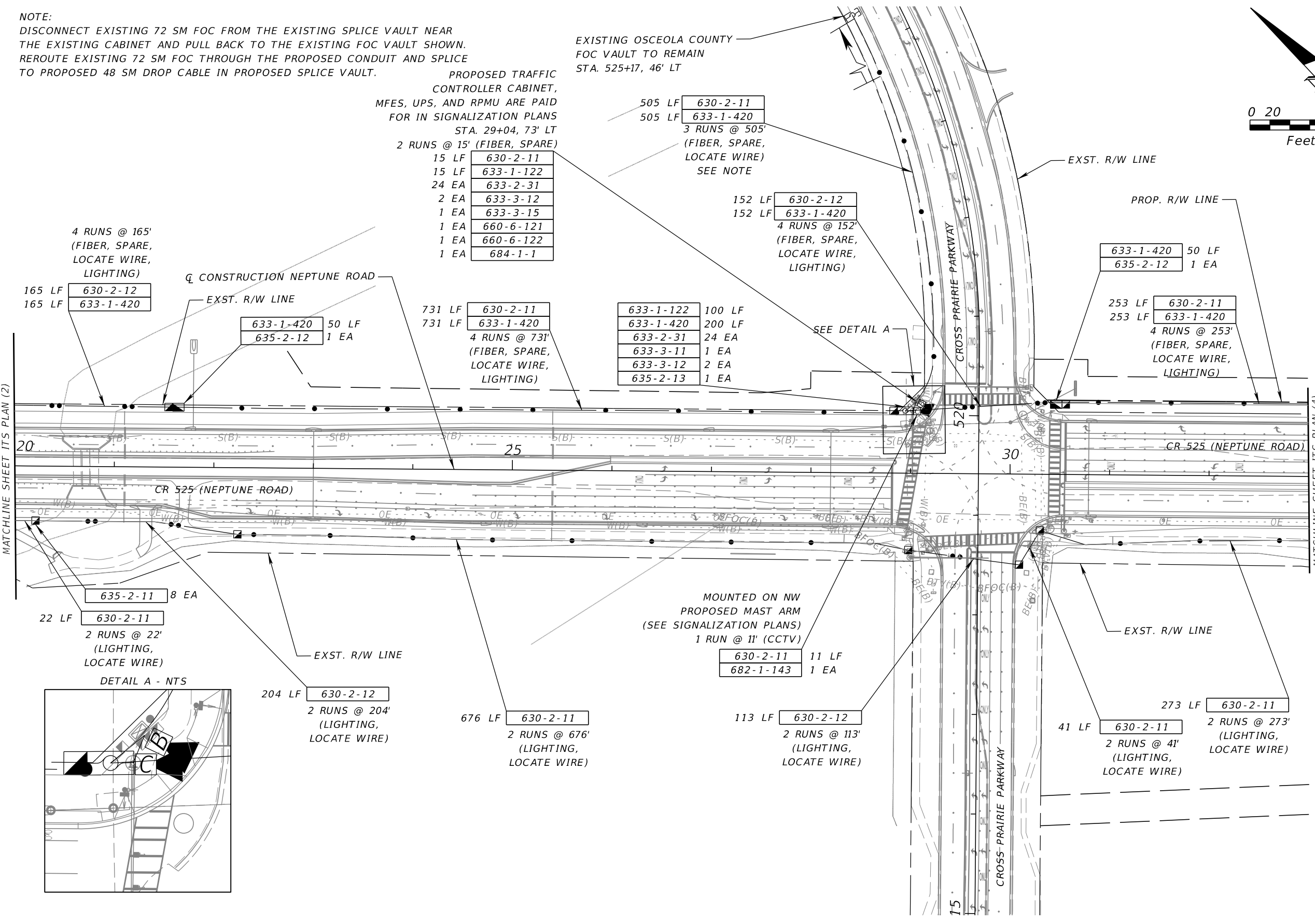

635-2-11 8 EA
 22 LF 630-2-11
 2 RUNS @ 22' (LIGHTING, LOCATE WIRE)

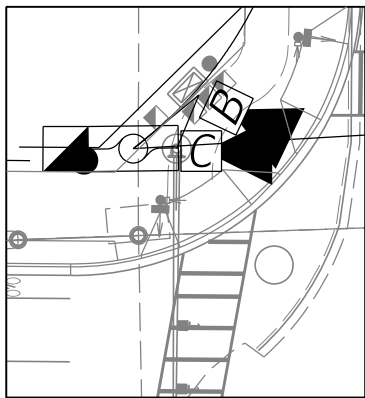

204 LF 630-2-12
 2 RUNS @ 204' (LIGHTING, LOCATE WIRE)

676 LF 630-2-11
 2 RUNS @ 676' (LIGHTING, LOCATE WIRE)

MOUNTED ON NW PROPOSED MAST ARM (SEE SIGNALIZATION PLANS)
 1 RUN @ 11' (CCTV)
 630-2-11 11 LF
 682-1-143 1 EA

113 LF 630-2-12
 2 RUNS @ 113' (LIGHTING, LOCATE WIRE)

41 LF 630-2-11
 2 RUNS @ 41' (LIGHTING, LOCATE WIRE)
 273 LF 630-2-11
 2 RUNS @ 273' (LIGHTING, LOCATE WIRE)

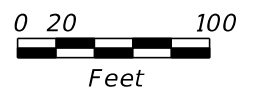

REVISIONS			
DATE	DESCRIPTION	DATE	DESCRIPTION

KEVIN R. CAREY, P.E.
 P.E. LICENSE NUMBER 61635
 FALLER, DAVIS & ASSOCIATES, INC.
 2301 MAITLAND CENTER PARKWAY, SUITE 265
 MAITLAND, FL 32751



OSCEOLA COUNTY TRANSIT AND TRANSPORTATION
 1 COURTHOUSE SQUARE, SUITE 3100
 KISSIMMEE, FLORIDA 34741-5488
 PHONE:(407) 742-0662 FAX:(407) 742-0600

ITS PLAN (3)

SHEET NO.
 IT-7

THE OFFICIAL RECORD OF THIS SHEET IS THE ELECTRONIC FILE DIGITALLY SIGNED AND SEALED UNDER RULE 61G15-23.004, F.A.C.

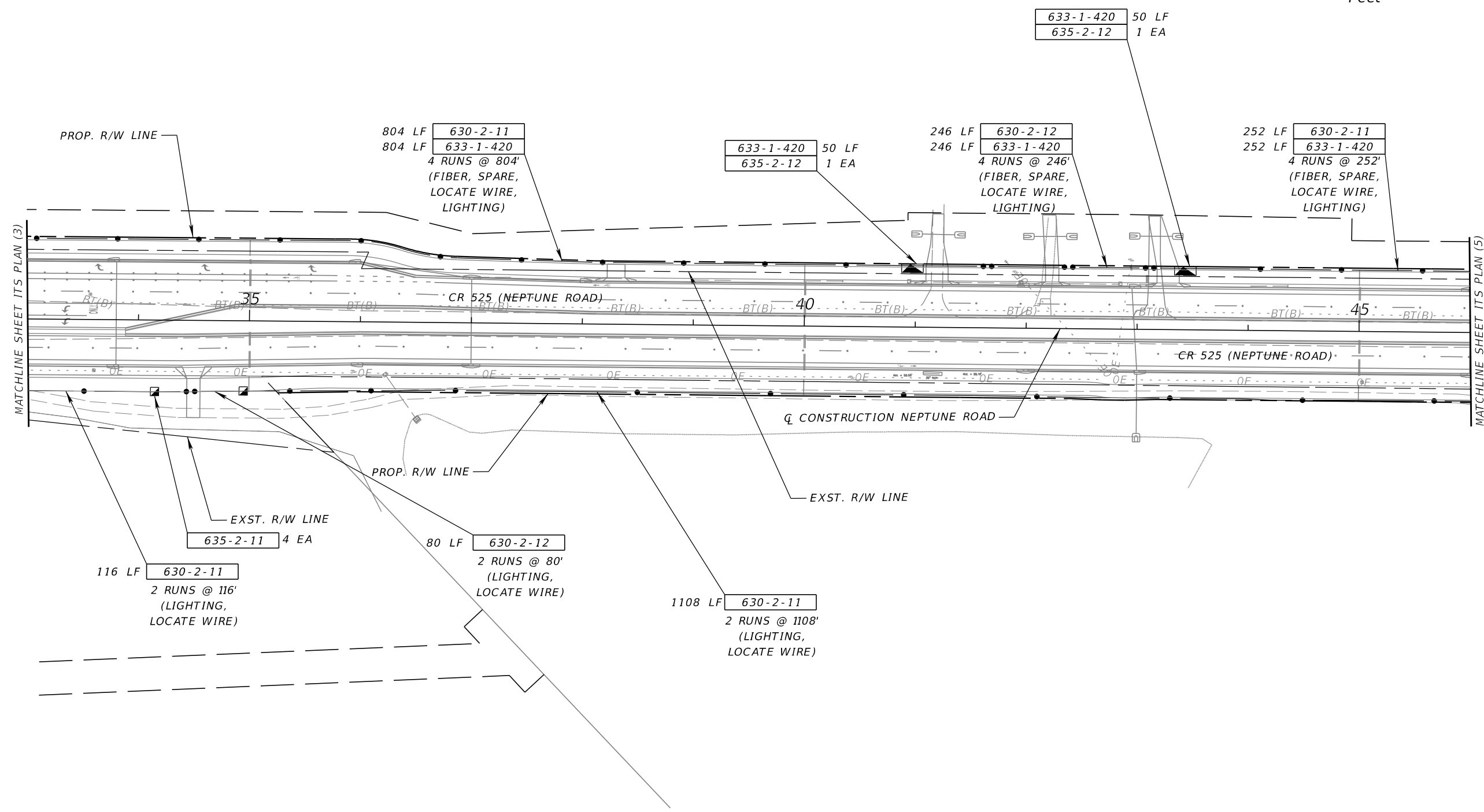
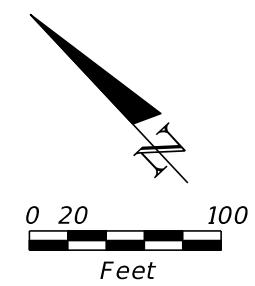

REVISIONS			
DATE	DESCRIPTION	DATE	DESCRIPTION

KEVIN R. CAREY, P.E.
 P.E. LICENSE NUMBER 61635
 FALLER, DAVIS & ASSOCIATES, INC.
 2301 MAITLAND CENTER PARKWAY, SUITE 265
 MAITLAND, FL 32751



OSCEOLA COUNTY TRANSIT
 AND TRANSPORTATION

1 COURTHOUSE SQUARE, SUITE 3100
 KISSIMMEE, FLORIDA 34741-5488
 PHONE:(407) 742-0662 FAX:(407) 742-0600

ITS PLAN (4)

SHEET NO.
 IT-8

THE OFFICIAL RECORD OF THIS SHEET IS THE ELECTRONIC FILE DIGITALLY SIGNED AND SEALED UNDER RULE 61G15-23.004, F.A.C.

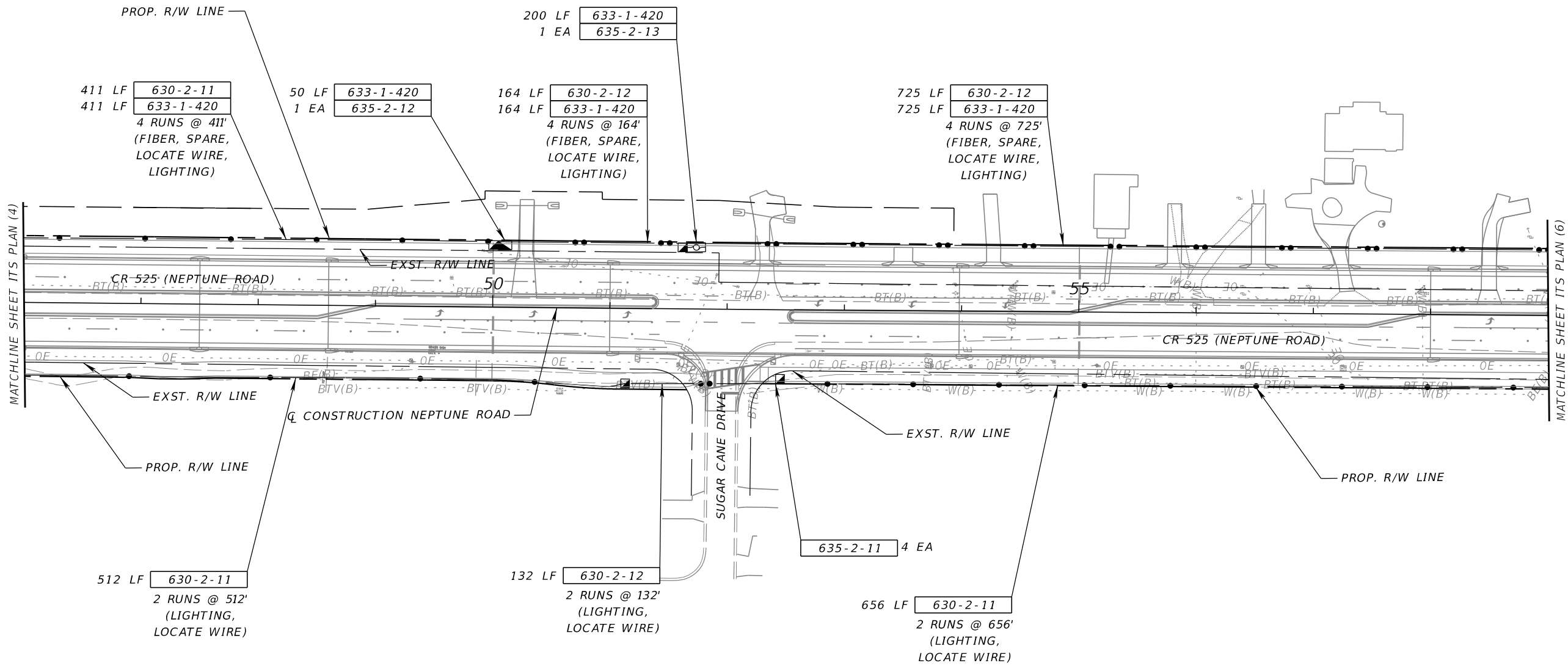
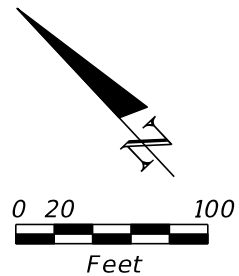

REVISIONS			
DATE	DESCRIPTION	DATE	DESCRIPTION

KEVIN R. CAREY, P.E.
 P.E. LICENSE NUMBER 61635
 FALLER, DAVIS & ASSOCIATES, INC.
 2301 MAITLAND CENTER PARKWAY, SUITE 265
 MAITLAND, FL 32751



OSCEOLA COUNTY TRANSIT
 AND TRANSPORTATION

1 COURTHOUSE SQUARE, SUITE 3100
 KISSIMMEE, FLORIDA 34741-5488
 PHONE:(407) 742-0662 FAX:(407) 742-0600

ITS PLAN (5)

SHEET NO.
 IT-9

THE OFFICIAL RECORD OF THIS SHEET IS THE ELECTRONIC FILE DIGITALLY SIGNED AND SEALED UNDER RULE 61G15-23.004, F.A.C.

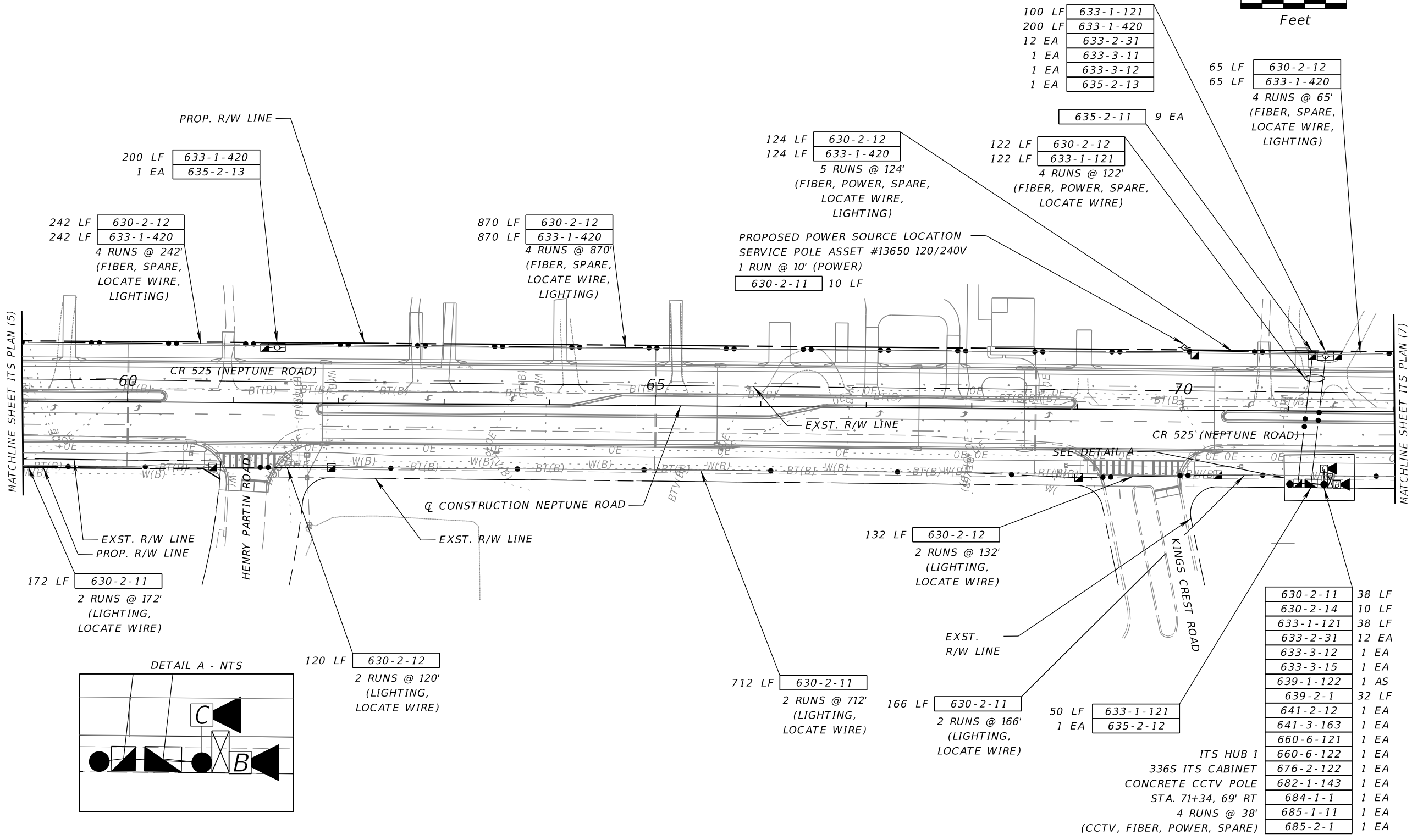
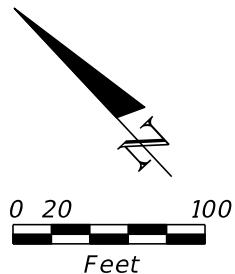

MATCHLINE SHEET ITS PLAN (5)

MATCHLINE SHEET ITS PLAN (7)

172 LF 630-2-11
2 RUNS @ 172'
(LIGHTING,
LOCATE WIRE)

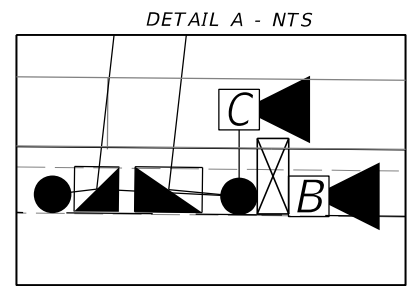

120 LF 630-2-12
2 RUNS @ 120'
(LIGHTING,
LOCATE WIRE)

712 LF 630-2-11
2 RUNS @ 712'
(LIGHTING,
LOCATE WIRE)

132 LF 630-2-12
2 RUNS @ 132'
(LIGHTING,
LOCATE WIRE)

166 LF 630-2-11
2 RUNS @ 166'
(LIGHTING,
LOCATE WIRE)

100 LF 633-1-121
200 LF 633-1-420
12 EA 633-2-31
1 EA 633-3-11
1 EA 633-3-12
1 EA 635-2-13

65 LF 630-2-12
65 LF 633-1-420
4 RUNS @ 65'
(FIBER, SPARE,
LOCATE WIRE,
LIGHTING)

635-2-11 9 EA

124 LF 630-2-12
124 LF 633-1-420
5 RUNS @ 124'
(FIBER, POWER, SPARE,
LOCATE WIRE,
LIGHTING)

122 LF 630-2-12
122 LF 633-1-121
4 RUNS @ 122'
(FIBER, POWER, SPARE,
LOCATE WIRE)

PROPOSED POWER SOURCE LOCATION
SERVICE POLE ASSET #13650 120/240V
1 RUN @ 10' (POWER)
630-2-11 10 LF

630-2-11	38 LF
630-2-14	10 LF
633-1-121	38 LF
633-2-31	12 EA
633-3-12	1 EA
633-3-15	1 EA
639-1-122	1 AS
639-2-1	32 LF
641-2-12	1 EA
641-3-163	1 EA
660-6-121	1 EA
660-6-122	1 EA
676-2-122	1 EA
682-1-143	1 EA
684-1-1	1 EA
685-1-11	1 EA
685-2-1	1 EA

ITS HUB 1
336S ITS CABINET
CONCRETE CCTV POLE
STA. 71+34, 69' RT
4 RUNS @ 38'
(CCTV, FIBER, POWER, SPARE)

REVISIONS			
DATE	DESCRIPTION	DATE	DESCRIPTION

KEVIN R. CAREY, P.E.
P.E. LICENSE NUMBER 61635
FALLER, DAVIS & ASSOCIATES, INC.
2301 MAITLAND CENTER PARKWAY, SUITE 265
MAITLAND, FL 32751



OSCEOLA COUNTY TRANSIT
AND TRANSPORTATION
1 COURTHOUSE SQUARE, SUITE 3100
KISSIMMEE, FLORIDA 34741-5488
PHONE:(407) 742-0662 FAX:(407) 742-0600

ITS PLAN (6)

SHEET NO.
IT-10

THE OFFICIAL RECORD OF THIS SHEET IS THE ELECTRONIC FILE DIGITALLY SIGNED AND SEALED UNDER RULE 61G15-23.004, F.A.C.

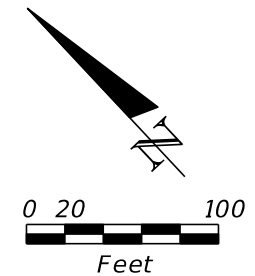

294 LF 630-2-12
 294 LF 633-1-420
 4 RUNS @ 294'
 (FIBER, SPARE,
 LOCATE WIRE,
 LIGHTING)

Q CONSTRUCTION NEPTUNE ROAD
 END ITS STA. 74+92.75

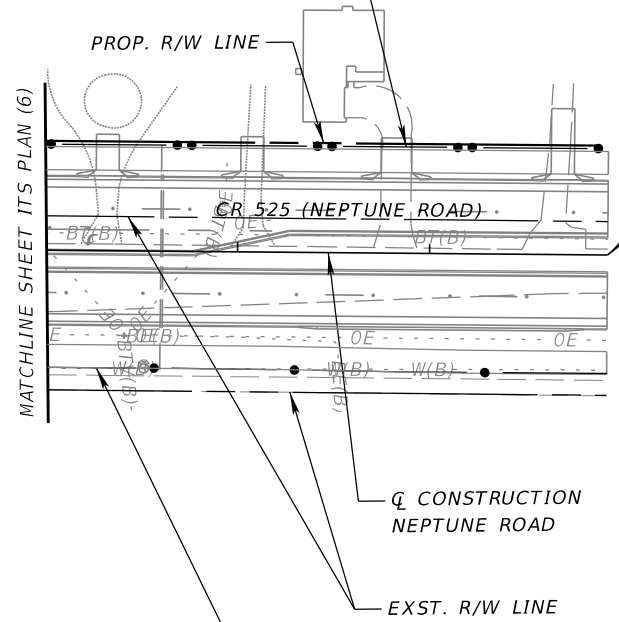

296 LF 630-2-11
 2 RUNS @ 296'
 (LIGHTING,
 LOCATE WIRE)

REVISIONS			
DATE	DESCRIPTION	DATE	DESCRIPTION

KEVIN R. CAREY, P.E.
 P.E. LICENSE NUMBER 61635
 FALLER, DAVIS & ASSOCIATES, INC.
 2301 MAITLAND CENTER PARKWAY, SUITE 265
 MAITLAND, FL 32751



OSCEOLA COUNTY TRANSIT
 AND TRANSPORTATION
 1 COURTHOUSE SQUARE, SUITE 3100
 KISSIMMEE, FLORIDA 34741-5488
 PHONE:(407) 742-0662 FAX:(407) 742-0600

ITS PLAN (7)

SHEET NO.
 IT-11

THE OFFICIAL RECORD OF THIS SHEET IS THE ELECTRONIC FILE DIGITALLY SIGNED AND SEALED UNDER RULE 61G15-23.004, F.A.C.

WIRING DIAGRAM 1: CCTV WITH BLUETOOTH READER IN EXISTING TRAFFIC CONTROLLER CABINET

NOTES

- COORDINATE WITH OSCEOLA COUNTY AT (407) 742-0565 FOR IP ADDRESSES AND COMMUNICATION PORT ASSIGNMENTS.

LEGEND

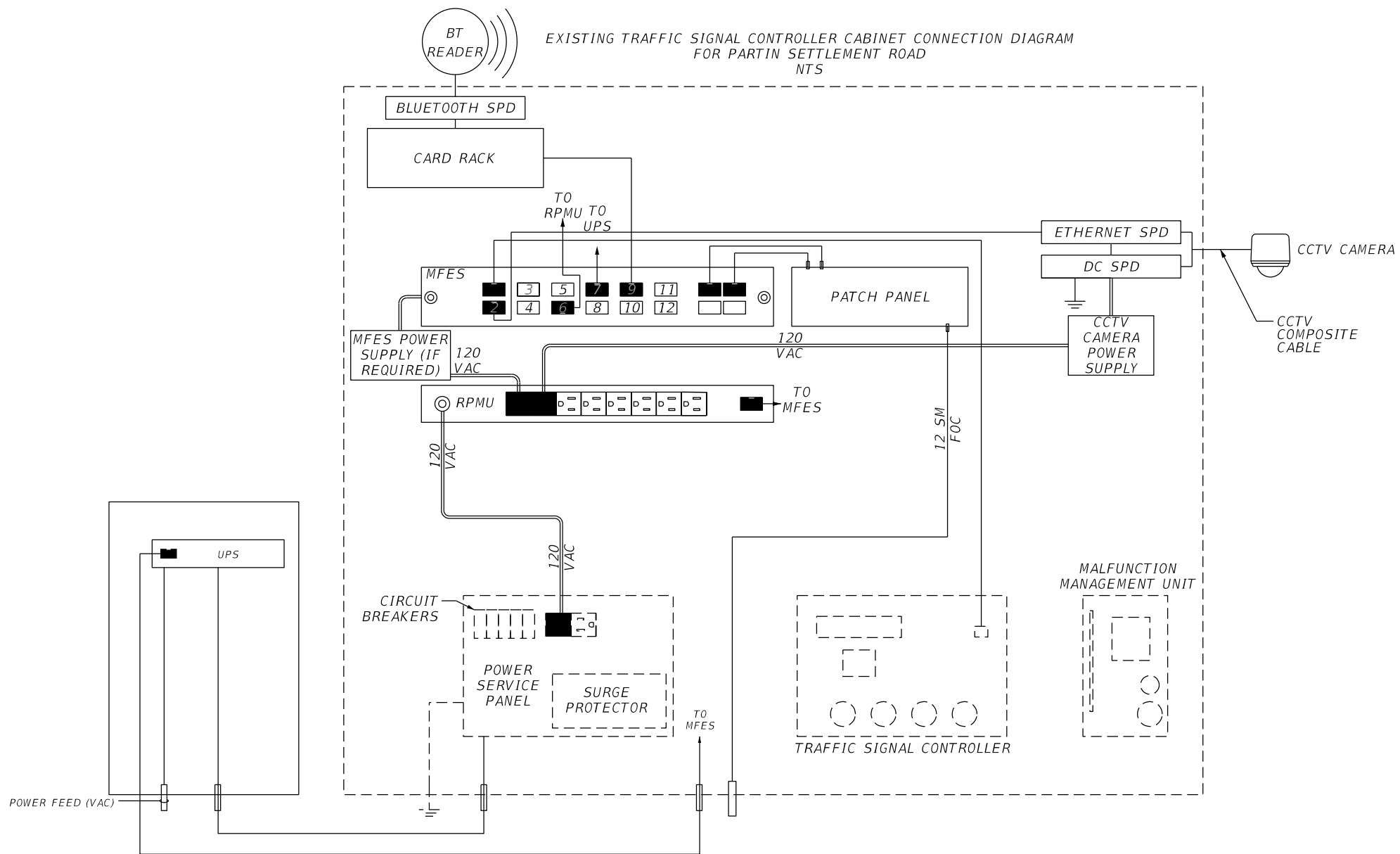
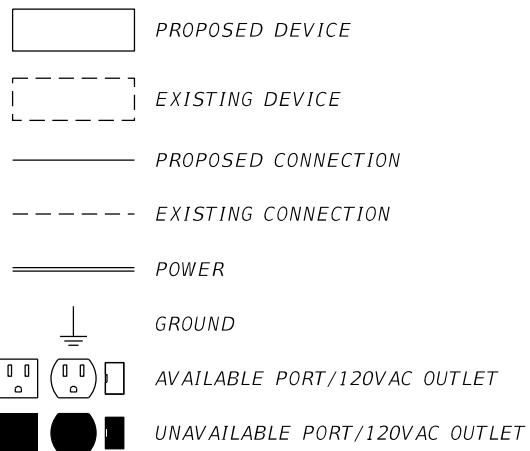

REVISIONS			
DATE	DESCRIPTION	DATE	DESCRIPTION

KEVIN R. CAREY, P.E.
 P.E. LICENSE NUMBER 61635
 FALLER, DAVIS & ASSOCIATES, INC.
 2301 MAITLAND CENTER PARKWAY, SUITE 265
 MAITLAND, FL 32751

 OSCEOLA COUNTY TRANSIT AND TRANSPORTATION
 1 COURTHOUSE SQUARE, SUITE 3100
 KISSIMMEE, FLORIDA 34741-5488
 PHONE:(407) 742-0662 FAX:(407) 742-0600

SHEET NO.
WIRING DIAGRAMS (1)
 IT-12

THE OFFICIAL RECORD OF THIS SHEET IS THE ELECTRONIC FILE DIGITALLY SIGNED AND SEALED UNDER RULE 61G15-23.004, F.A.C.

WIRING DIAGRAM 2: CCTV WITH BLUETOOTH READER IN PROPOSED SIGNAL CABINET

NOTES

- COORDINATE WITH OSCEOLA COUNTY AT (407) 742-0565 FOR IP ADDRESSES AND COMMUNICATION PORT ASSIGNMENTS.
- PROPOSED EQUIPMENT MARKED WITH AN "*" ARE INCLUDED IN THE SIGNAL PLANS.

LEGEND

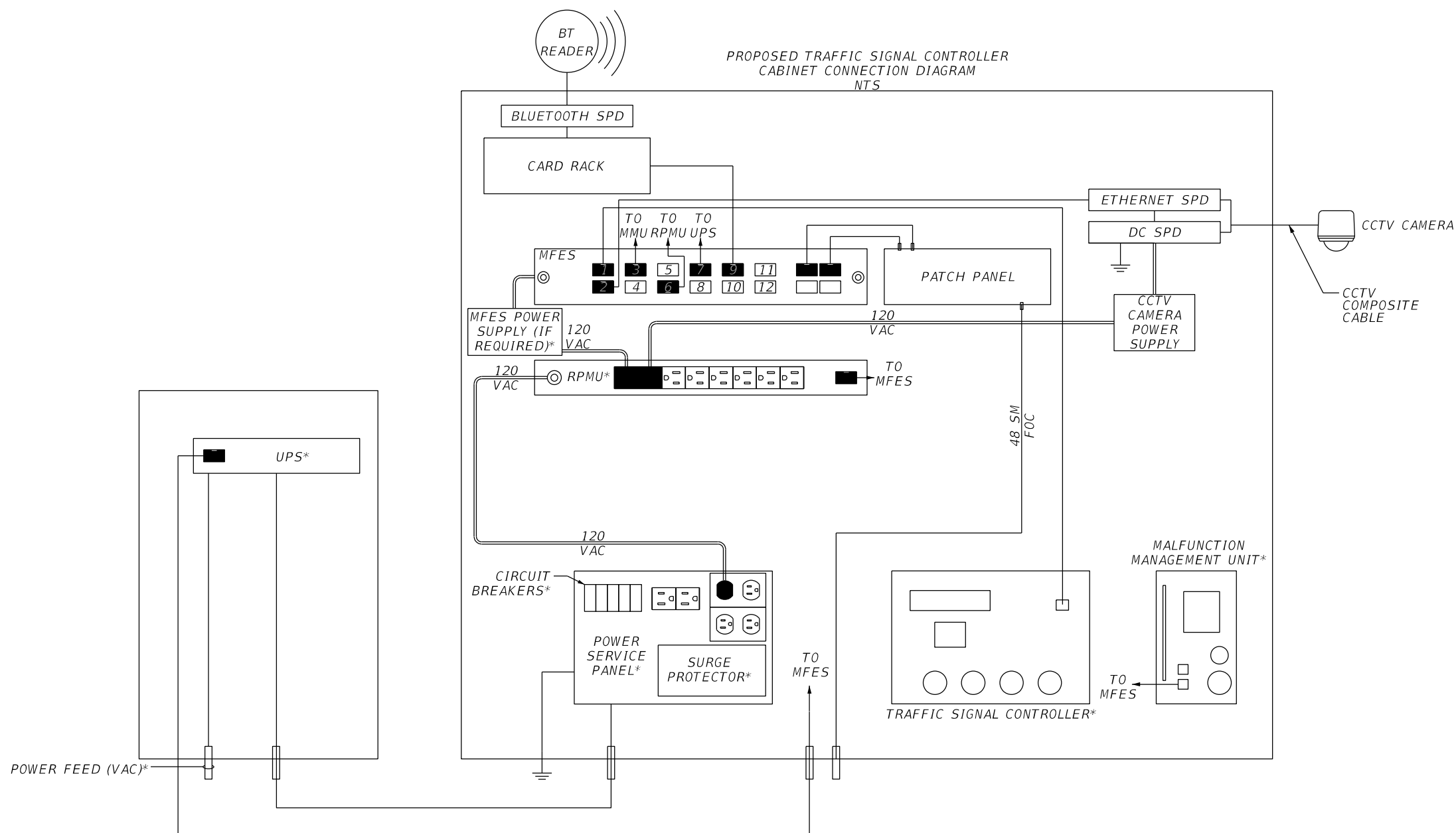
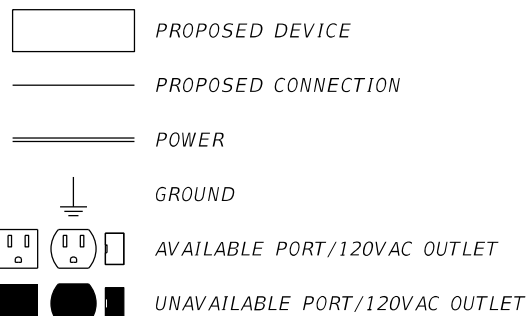

REVISIONS			
DATE	DESCRIPTION	DATE	DESCRIPTION

KEVIN R. CAREY, P.E.
 P.E. LICENSE NUMBER 61635
 FALLER, DAVIS & ASSOCIATES, INC.
 2301 MAITLAND CENTER PARKWAY, SUITE 265
 MAITLAND, FL 32751

OSCEOLA COUNTY TRANSIT AND TRANSPORTATION
 1 COURTHOUSE SQUARE, SUITE 3100
 KISSIMMEE, FLORIDA 34741-5488
 PHONE:(407) 742-0662 FAX:(407) 742-0600

WIRING DIAGRAMS (2)
 SHEET NO. IT-13

THE OFFICIAL RECORD OF THIS SHEET IS THE ELECTRONIC FILE DIGITALLY SIGNED AND SEALED UNDER RULE 61G15-23.004, F.A.C.

WIRING DIAGRAM 3: CCTV WITH BLUETOOTH READER IN 336S CABINET

NOTES

- COORDINATE WITH OSCEOLA COUNTY AT (407) 742-0565 FOR IP ADDRESSES AND COMMUNICATION PORT ASSIGNMENTS.
- BOTH VERTICAL AND HORIZONTAL CABLE MANAGEMENT SHALL NOT INTERFERE WITH THE CABINET DOOR OPERATION.

LEGEND

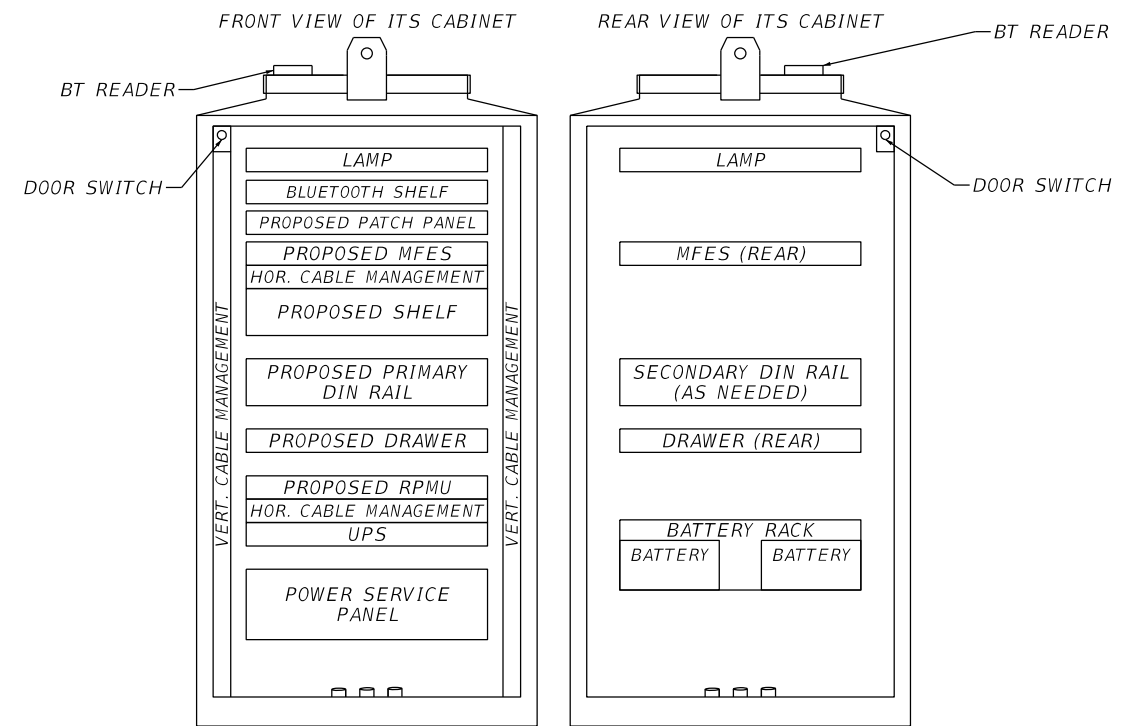
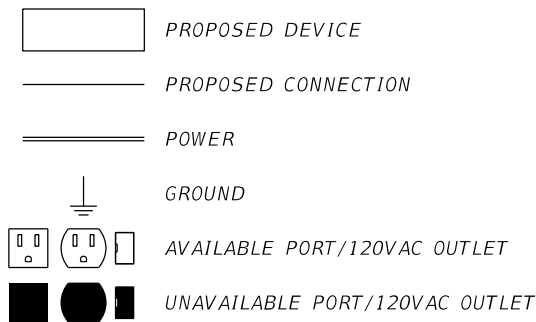

PROPOSED 336S CABINET CONNECTION DIAGRAM NTS

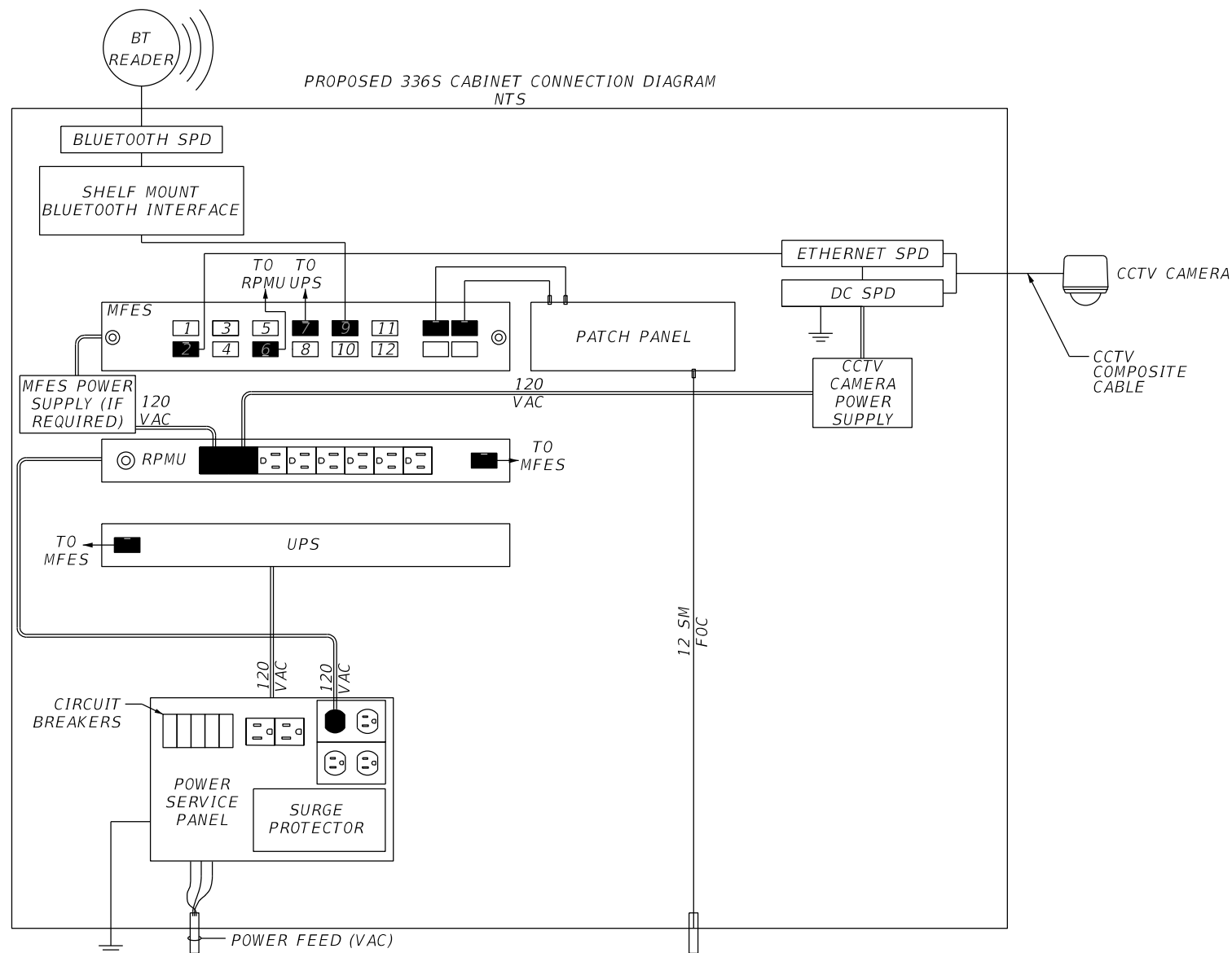

REVISIONS			
DATE	DESCRIPTION	DATE	DESCRIPTION

KEVIN R. CAREY, P.E.
 P.E. LICENSE NUMBER 61635
 FALLER, DAVIS & ASSOCIATES, INC.
 2301 MAITLAND CENTER PARKWAY, SUITE 265
 MAITLAND, FL 32751

OSCEOLA COUNTY TRANSIT AND TRANSPORTATION
 1 COURTHOUSE SQUARE, SUITE 3100
 KISSIMMEE, FLORIDA 34741-5488
 PHONE: (407) 742-0662 FAX: (407) 742-0600

WIRING DIAGRAMS (3)

SHEET NO.
IT-14

THE OFFICIAL RECORD OF THIS SHEET IS THE ELECTRONIC FILE DIGITALLY SIGNED AND SEALED UNDER RULE 61G15-23.004, F.A.C.

LEGEND

- PROPOSED DEVICE
- PROPOSED CONNECTION

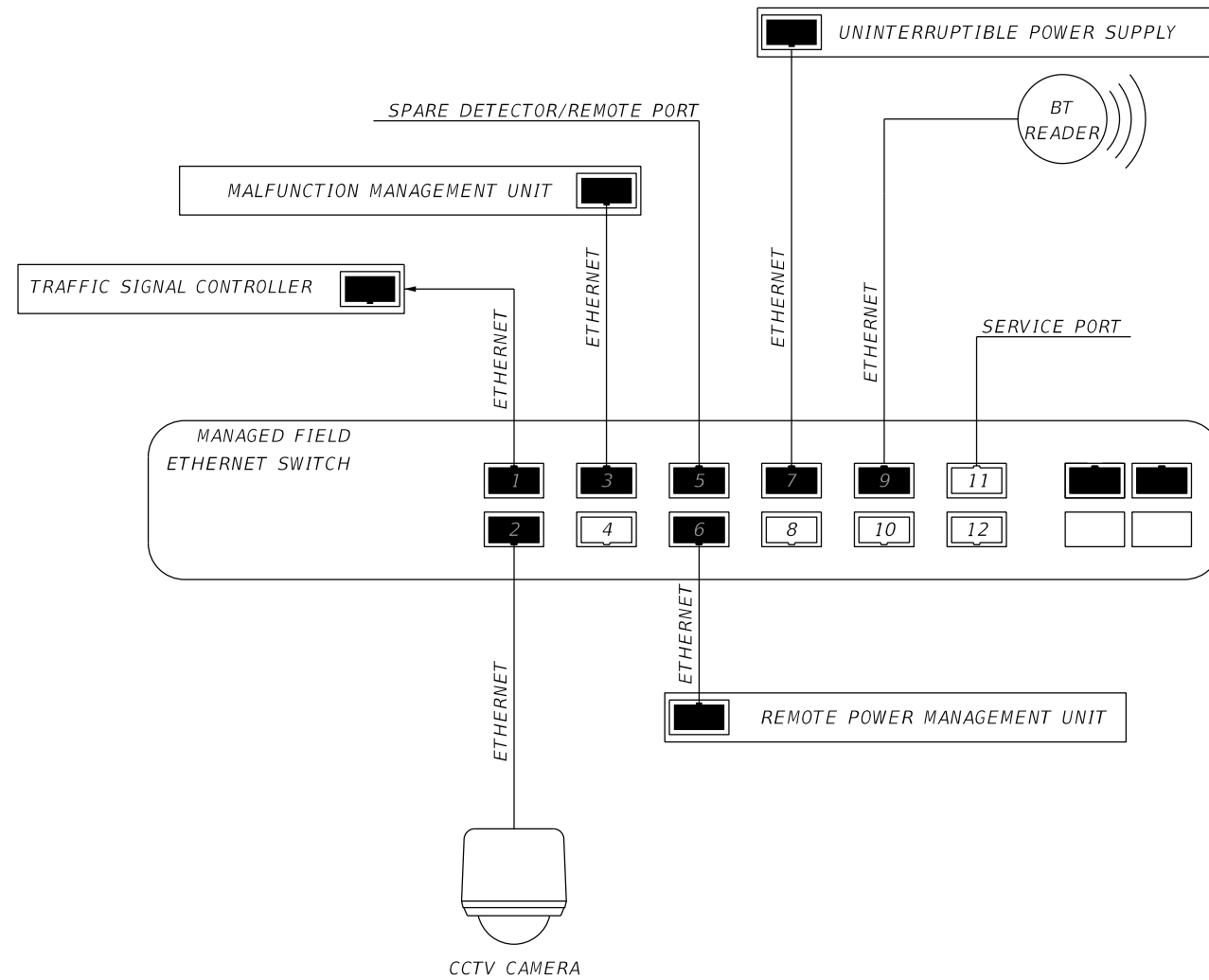

REVISIONS			
DATE	DESCRIPTION	DATE	DESCRIPTION

KEVIN R. CAREY, P.E.
 P.E. LICENSE NUMBER 61635
 FALLER, DAVIS & ASSOCIATES, INC.
 2301 MAITLAND CENTER PARKWAY, SUITE 265
 MAITLAND, FL 32751



OSCEOLA COUNTY TRANSIT
 AND TRANSPORTATION

1 COURTHOUSE SQUARE, SUITE 3100
 KISSIMMEE, FLORIDA 34741-5488
 PHONE:(407) 742-0662 FAX:(407) 742-0600

**MANAGED FIELD ETHERNET
 SWITCH DETAIL**

SHEET NO.
 IT-15

THE OFFICIAL RECORD OF THIS SHEET IS THE ELECTRONIC FILE DIGITALLY SIGNED AND SEALED UNDER RULE 61G15-23.004, F.A.C.

TYPICAL 1: PROPOSED CCTV/BT TO EXISTING MAST ARM AND CONTROLLER CABINET

NOTES

1. INSTALLATION PROCEDURES FOR CCTV CAMERA AND BLUETOOTH READER SHALL MEET MANUFACTURER'S RECOMMENDATIONS.
2. MOUNTING HEIGHT FOR CCTV CAMERA SHALL MEET MANUFACTURER'S RECOMMENDATIONS.
3. MOUNT CAMERA ON POLE FACING ROADWAY TO BE OBSERVED.
4. DEVICE CABLE SHALL BE ROUTED THROUGH EXISTING CABLE ENTRY HOLE. IF CABLE ENTRY HOLE IS NOT READILY AVAILABLE, NEW ENTRY HOLE MAY BE DRILLED INTO MAST ARM, AS APPROVED BY ENGINEER.
5. CCTV CAMERA CABLE TO BE ROUTED THROUGH EXISTING CONDUIT IN MAST ARM BASE. IF EXISTING CONDUIT IS NOT ACCESSIBLE, PROPOSED ABOVE GROUND CONDUIT SHOULD BE USED.

LEGEND

- PROPOSED EQUIPMENT
- - - EXISTING EQUIPMENT
- - - COMPOSITE CABLE

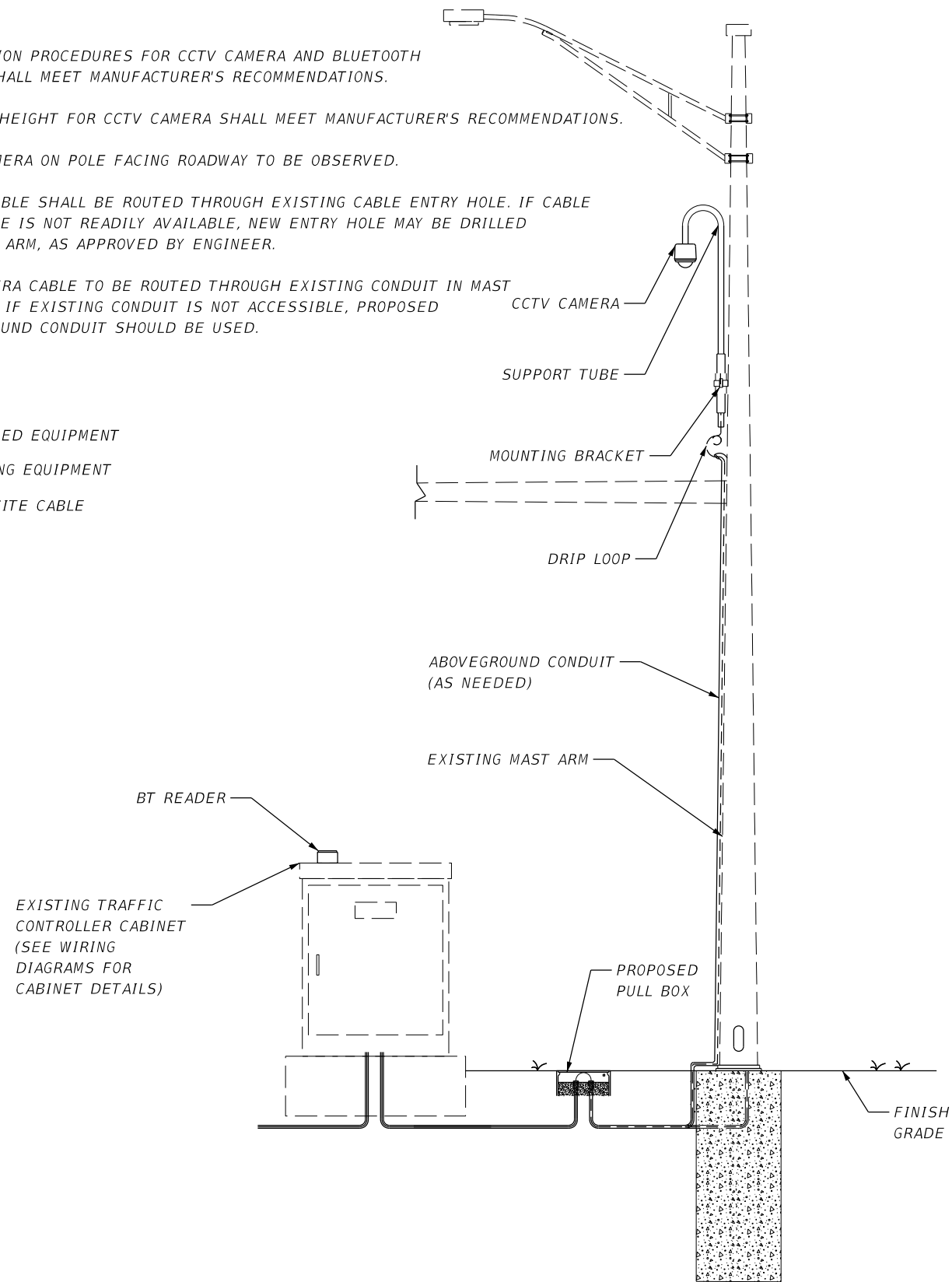

TYPICAL 2: PROPOSED CCTV/BT TO PROPOSED MAST ARM AND CONTROLLER CABINET

NOTES

1. INSTALLATION PROCEDURES FOR CCTV CAMERA AND BLUETOOTH READER SHALL MEET MANUFACTURER'S RECOMMENDATIONS.
2. MOUNTING HEIGHT FOR CCTV CAMERA SHALL MEET MANUFACTURER'S RECOMMENDATIONS.
3. MOUNT CAMERA ON POLE FACING ROADWAY TO BE OBSERVED.

LEGEND

- PROPOSED EQUIPMENT
- - - COMPOSITE CABLE

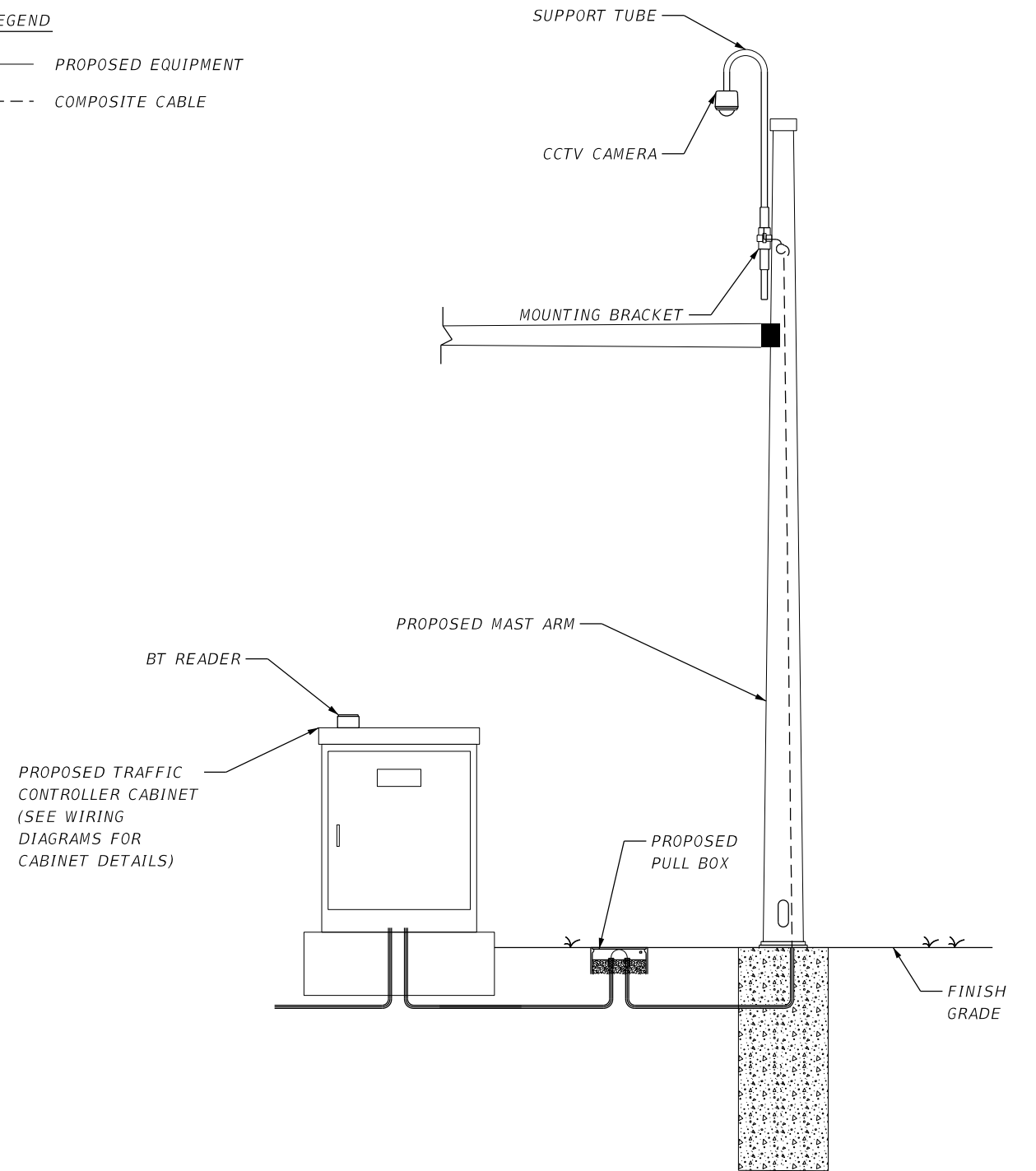

REVISIONS			
DATE	DESCRIPTION	DATE	DESCRIPTION

KEVIN R. CAREY, P.E.
 P.E. LICENSE NUMBER 61635
 FALLER, DAVIS & ASSOCIATES, INC.
 2301 MAITLAND CENTER PARKWAY, SUITE 265
 MAITLAND, FL 32751

OSCEOLA COUNTY TRANSIT AND TRANSPORTATION
 1 COURTHOUSE SQUARE, SUITE 3100
 KISSIMMEE, FLORIDA 34741-5488
 PHONE:(407) 742-0662 FAX:(407) 742-0600

MOUNTING DETAILS (1)

SHEET NO.
 IT-16

THE OFFICIAL RECORD OF THIS SHEET IS THE ELECTRONIC FILE DIGITALLY SIGNED AND SEALED UNDER RULE 61G15-23.004, F.A.C.

TYPICAL 3: PROPOSED CCTV/BT STRUCTURE

NOTES

1. INSTALLATION PROCEDURES FOR CCTV CAMERA AND BLUETOOTH READER SHALL MEET MANUFACTURER'S RECOMMENDATIONS.
2. MOUNTING HEIGHT FOR CCTV CAMERA SHALL MEET MANUFACTURER'S RECOMMENDATIONS.
3. MOUNT CAMERA ON POLE FACING ROADWAY TO BE OBSERVED.

LEGEND

- PROPOSED EQUIPMENT
- - - COMPOSITE CABLE

CCTV POLE LENGTH

ITS HUB NO. 1
 TOTAL POLE LENGTH: 63'
 BURIED POLE DEPTH: 13'

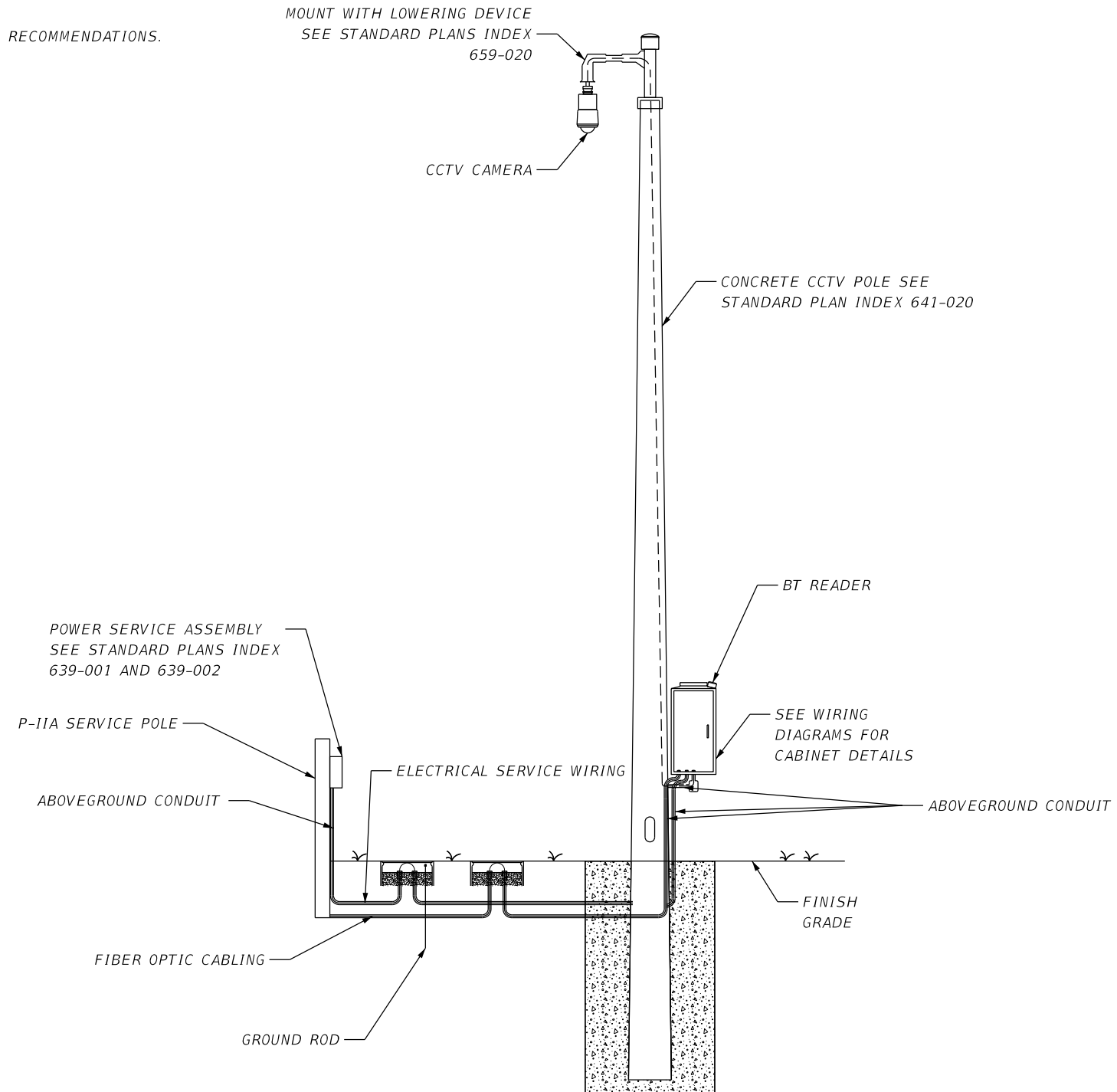

REVISIONS			
DATE	DESCRIPTION	DATE	DESCRIPTION

KEVIN R. CAREY, P.E.
 P.E. LICENSE NUMBER 61635
 FALLER, DAVIS & ASSOCIATES, INC.
 2301 MAITLAND CENTER PARKWAY, SUITE 265
 MAITLAND, FL 32751



OSCEOLA COUNTY TRANSIT
 AND TRANSPORTATION

1 COURTHOUSE SQUARE, SUITE 3100
 KISSIMMEE, FLORIDA 34741-5488
 PHONE:(407) 742-0662 FAX:(407) 742-0600

MOUNTING DETAILS (2)

SHEET NO.
 IT-17

THE OFFICIAL RECORD OF THIS SHEET IS THE ELECTRONIC FILE DIGITALLY SIGNED AND SEALED UNDER RULE 61G15-23.004, F.A.C.

EXISTING TRAFFIC CONTROLLER CABINET -
NEPTUNE ROAD AT PARTIN SETTLEMENT ROAD

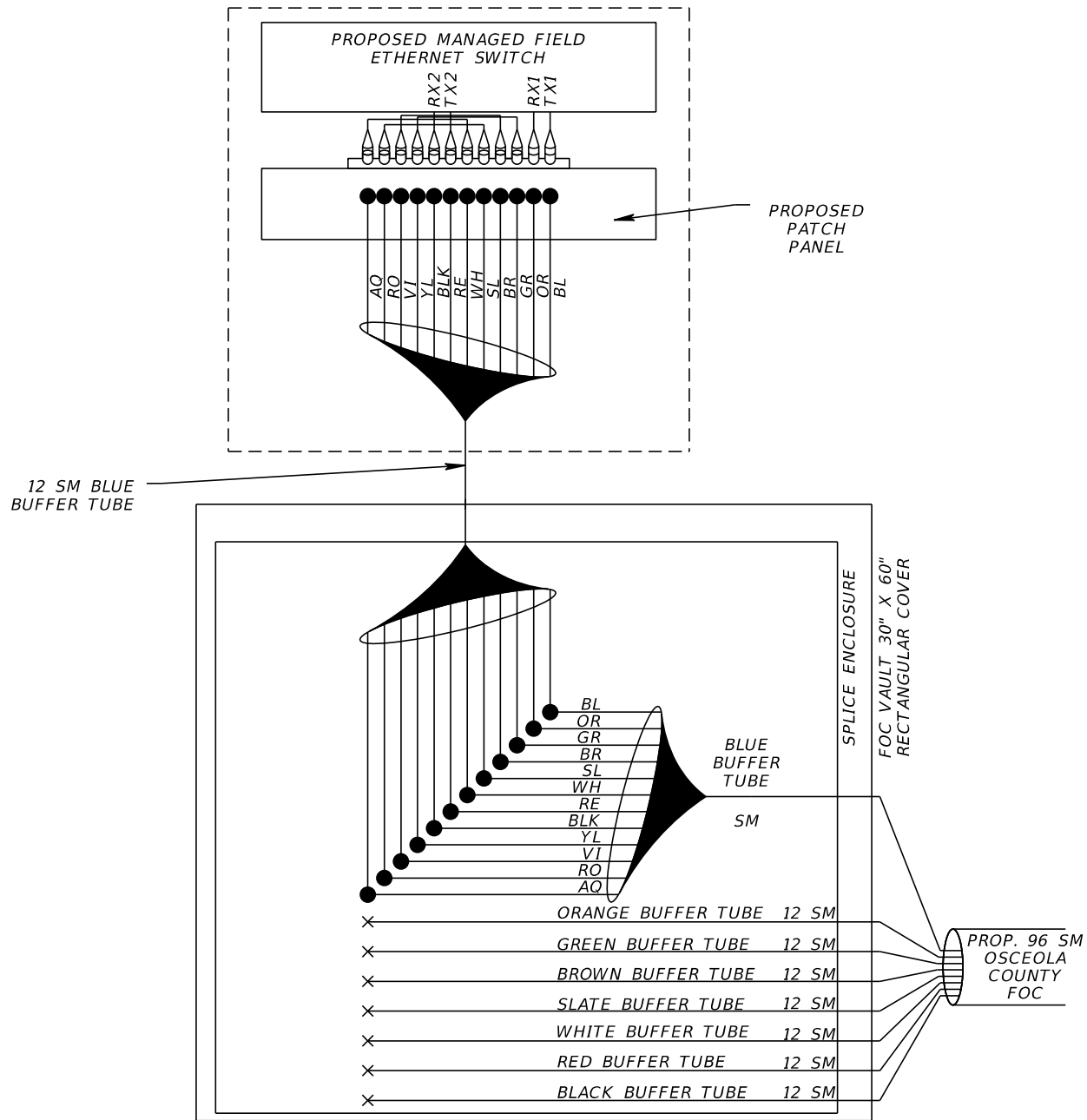

NOTES:

1. UNUSED FIBERS SHALL BE COILED AND STORED IN SPLICE ENCLOSURE OR SPLICE TRAY.
2. UNUSED BUFFER TUBE SHALL BE COILED AND STORED IN THE SPLICE ENCLOSURE OR PATCH PANEL.

REVISIONS			
DATE	DESCRIPTION	DATE	DESCRIPTION

KEVIN R. CAREY, P.E.
P.E. LICENSE NUMBER 61635
FALLER, DAVIS & ASSOCIATES, INC.
2301 MAITLAND CENTER PARKWAY, SUITE 265
MAITLAND, FL 32751



OSCEOLA COUNTY TRANSIT
AND TRANSPORTATION
1 COURTHOUSE SQUARE, SUITE 3100
KISSIMMEE, FLORIDA 34741-5488
PHONE:(407) 742-0662 FAX:(407) 742-0600

SPLICE DIAGRAM (1)

SHEET
NO.

IT-18

THE OFFICIAL RECORD OF THIS SHEET IS THE ELECTRONIC FILE DIGITALLY SIGNED AND SEALED UNDER RULE 61G15-23.004, F.A.C.

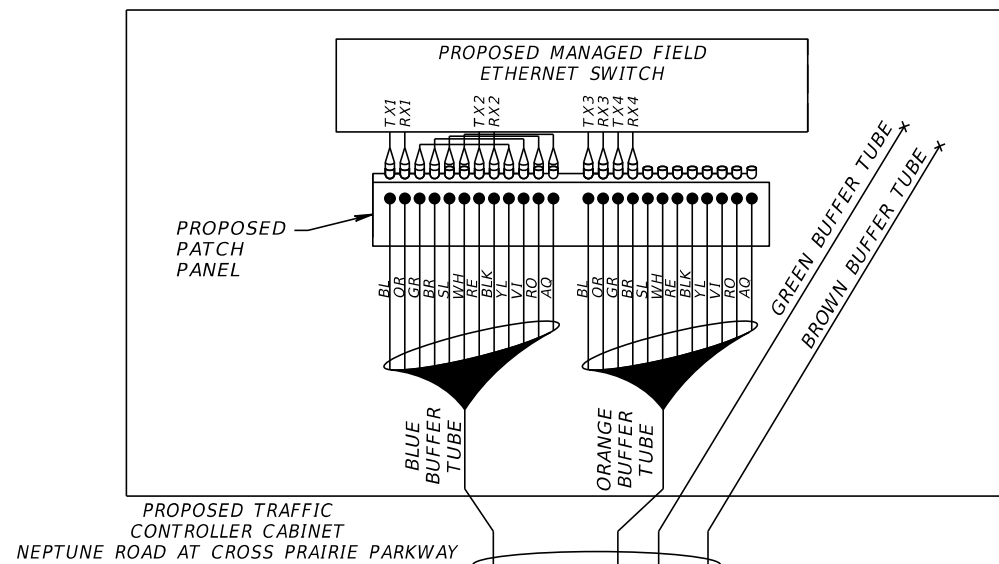

PROPOSED TRAFFIC CONTROLLER CABINET
NEPTUNE ROAD AT CROSS PRAIRIE PARKWAY

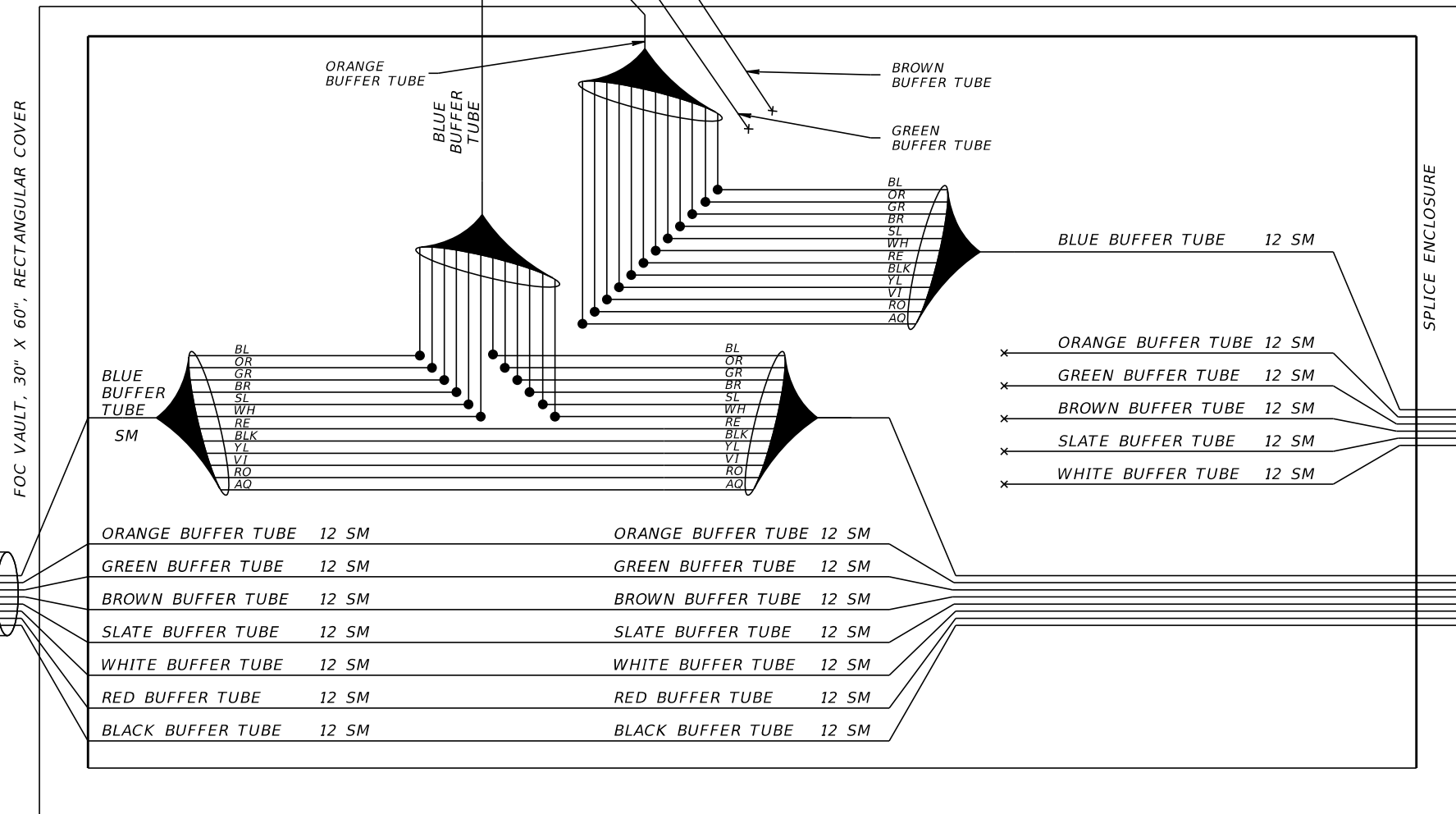
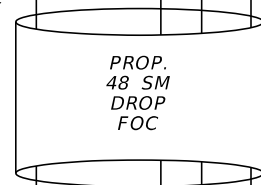

- NOTES:
1. UNUSED FIBERS SHALL BE COILED STORED IN SPLICE ENCLOSURE OR SPLICE TRAY.
 2. UNUSED BUFFER TUBE SHALL BE COILED AND STORED IN THE SPLICE ENCLOSURE OR PATCH PANEL.

REVISIONS			
DATE	DESCRIPTION	DATE	DESCRIPTION

KEVIN R. CAREY, P.E.
P.E. LICENSE NUMBER 61635
FALLER, DAVIS & ASSOCIATES, INC.
2301 MAITLAND CENTER PARKWAY, SUITE 265
MAITLAND, FL 32751



OSCEOLA COUNTY TRANSIT AND TRANSPORTATION
1 COURTHOUSE SQUARE, SUITE 3100
KISSIMMEE, FLORIDA 34741-5488
PHONE:(407) 742-0662 FAX:(407) 742-0600

SPLICE DIAGRAM (2)

SHEET NO.

IT-19

ITS HUB 1
PROPOSED 336S ITS CABINET
CONTROLLER CABINET

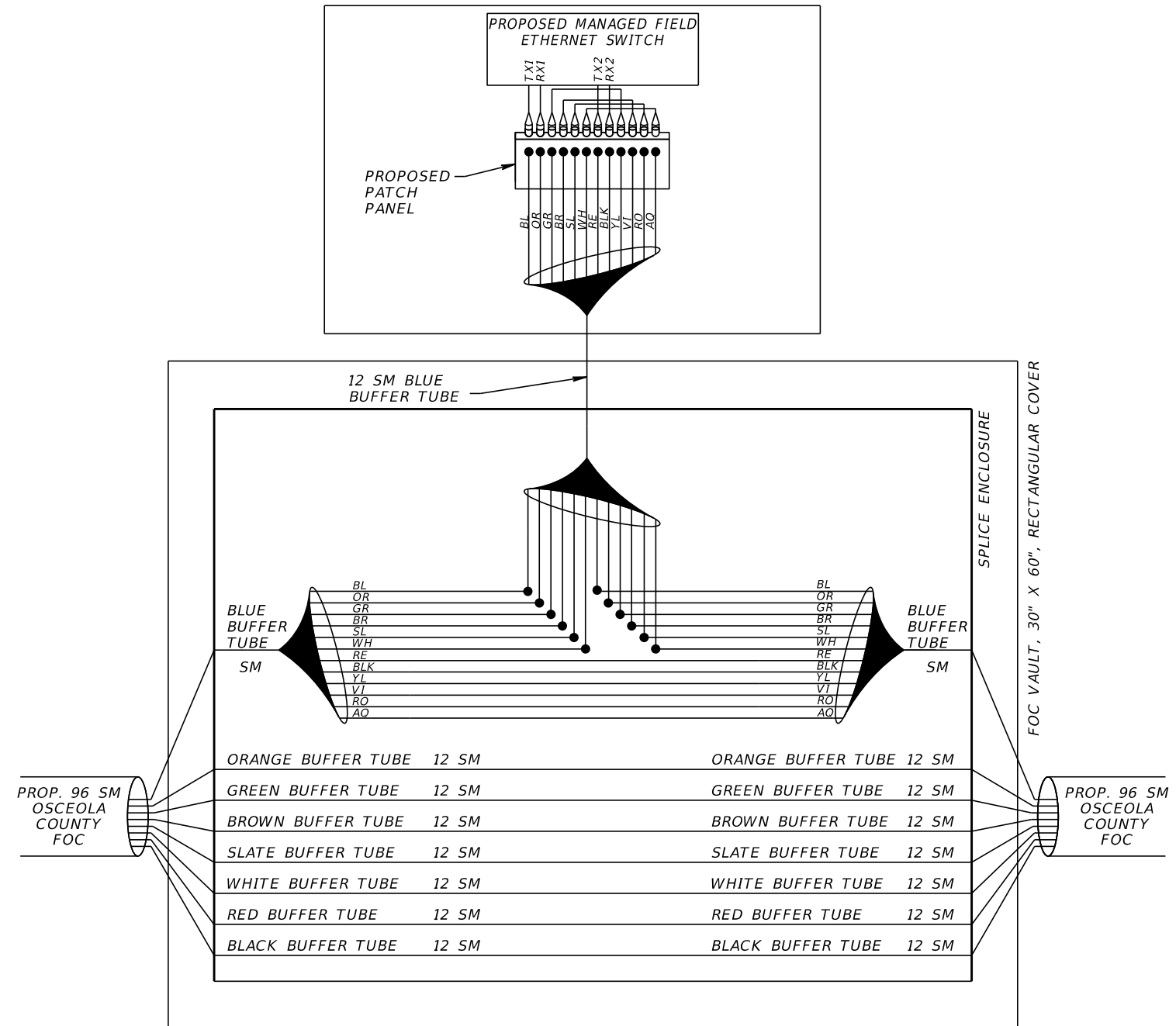

- NOTES:
1. UNUSED FIBERS SHALL BE COILED STORED IN SPLICE ENCLOSURE OR SPLICE TRAY.
 2. UNUSED BUFFER TUBE SHALL BE COILED AND STORED IN THE SPLICE ENCLOSURE OR PATCH PANEL.

REVISIONS			
DATE	DESCRIPTION	DATE	DESCRIPTION

KEVIN R. CAREY, P.E.
P.E. LICENSE NUMBER 61635
FALLER, DAVIS & ASSOCIATES, INC.
2301 MAITLAND CENTER PARKWAY, SUITE 265
MAITLAND, FL 32751

 OSCEOLA COUNTY TRANSIT AND TRANSPORTATION
1 COURTHOUSE SQUARE, SUITE 3100
KISSIMMEE, FLORIDA 34741-5488
PHONE:(407) 742-0662 FAX:(407) 742-0600

SPLICE DIAGRAM (3)

SHEET NO.
IT-20

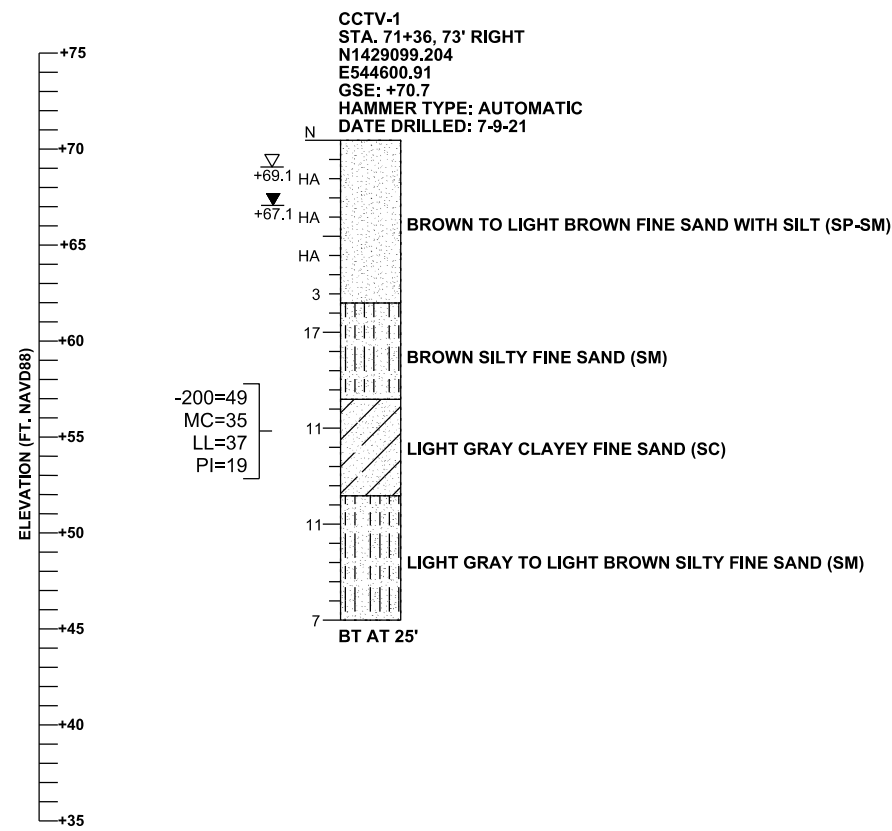
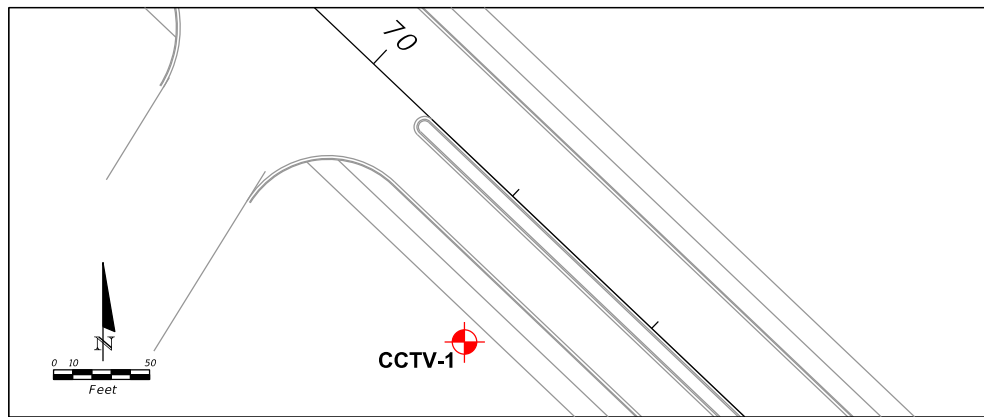

LEGEND

- GSE GROUND SURFACE ELEVATION (FT. NAVD88)
 - N STANDARD PENETRATION RESISTANCE, BLOWS PER FOOT
 - HA HAND AUGERED FOR UTILITY CLEARANCE
 - ▽+69.1 ESTIMATED SEASONAL HIGH GROUNDWATER ELEVATION (FT. NAVD88)
 - ▼+67.1 ENCOUNTERED GROUNDWATER ELEVATION (FT. NAVD)
 - BT BORING TERMINATED AT DEPTH INDICATED
 - 200= PERCENT PASSING NO. 200 U.S. STANDARD SIEVE
 - MC= PERCENT NATURAL MOISTURE CONTENT
 - LL= LIQUID LIMIT
 - PI= PLASTICITY INDEX
- SAND
 - SAND AND SILT
 - SAND AND CLAY

GENERAL NOTES

SUBSURFACE CONDITIONS SHOWN ON THE BORINGS REPRESENT THE CONDITIONS ENCOUNTERED AT THE BORING LOCATIONS. ACTUAL CONDITIONS BETWEEN THE BORINGS MAY VARY FROM THOSE SHOWN. UNIFIED SOIL CLASSIFICATIONS SHOWN ON THE BORINGS ARE BASED ON VISUAL EXAMINATION AND THE LABORATORY TESTING SHOWN.

STANDARD PENETRATION TEST BORINGS WERE PERFORMED IN ACCORDANCE WITH ASTM D-1586. STANDARD PENETRATION RESISTANCES ARE SHOWN ON THE BORINGS AT THE TEST DEPTHS IN BLOWS PER FOOT UNLESS OTHERWISE NOTED.

THE BORING LOCATIONS WERE NOT SURVEYED. BORING LOCATIONS WERE ESTABLISHED IN THE FIELD USING A HANDHELD SUB-METER ACCURACY TRIMBLE GPS UNIT.

BASED ON REVIEW OF THE FDEP MAP ENTITLED "UPPER FLORIDA AQUIFER POTENTIOMETRIC SURFACE", DATED SEPTEMBER 2017". THE MAXIMUM ELEVATION OF THE ARTESIAN HEAD IS ESTIMATED TO BE APPROXIMATELY +50 FT. NAVD88. THE CONTRACTOR SHALL BE PREPARED TO HANDLE ARTESIAN HEAD LEVELS UP TO +50 FT. NAVD88.

SPLIT SPOON SAMPLER:
 INSIDE DIAMETER: 1.375 IN.
 OUTSIDE DIAMETER: 2.0 IN.
 AVERAGE HAMMER DROP: 30 IN.
 HAMMER WEIGHT: 140 LBS.

AUTOMATIC HAMMER			
GRANULAR SOILS: SANDS		NON-GRANULAR SOILS: SILTS, CLAYS, MUCK	
N VALUE (BLOWS/FT)	RELATIVE DENSITY	N VALUE (BLOWS/FT)	CONSISTENCY
0-3	VERY LOOSE	0-1	VERY SOFT
3-8	LOOSE	1-3	SOFT
8-24	MEDIUM DENSE	3-6	FIRM
24-40	DENSE	6-12	STIFF
OVER 40	VERY DENSE	12-24	VERY STIFF
		OVER 24	HARD

REVISIONS			
DATE	DESCRIPTION	DATE	DESCRIPTION

2510 MICHIGAN AVE., SUITE D
 KISSIMMEE, FL 34744
 CHRISTOPHER P. MEYER, P.E.
 P.E. LICENSE NUMBER 49328
 GEC J4617G

OSCEOLA COUNTY TRANSIT
 AND TRANSPORTATION

1 COURTHOUSE SQUARE, SUITE 3100
 KISSIMMEE, FLORIDA 34741-5488
 PHONE:(407) 742-0662 FAX:(407) 742-0600

**REPORT OF SPT BORINGS
 FOR CCTV POLES**

SHEET NO.
 IT-21

THE OFFICIAL RECORD OF THIS SHEET IS THE ELECTRONIC FILE DIGITALLY SIGNED AND SEALED UNDER RULE 61G15-23.004, F.A.C.